



# **MX FUEL™ 600 MM EDGING TROWEL**

MXF WBT60

MAINTENANCE SCHEDULE





**MXF WBT60**

## **Our MX FUEL™ Models are designed to require minimum maintenance.**

Battery powered Equipment has all the power of petrol with no fumes or complex maintenance.

This guide will give you all information needed to help extend the lifetime of your MXF walk behind trowel and get the best performance possible.

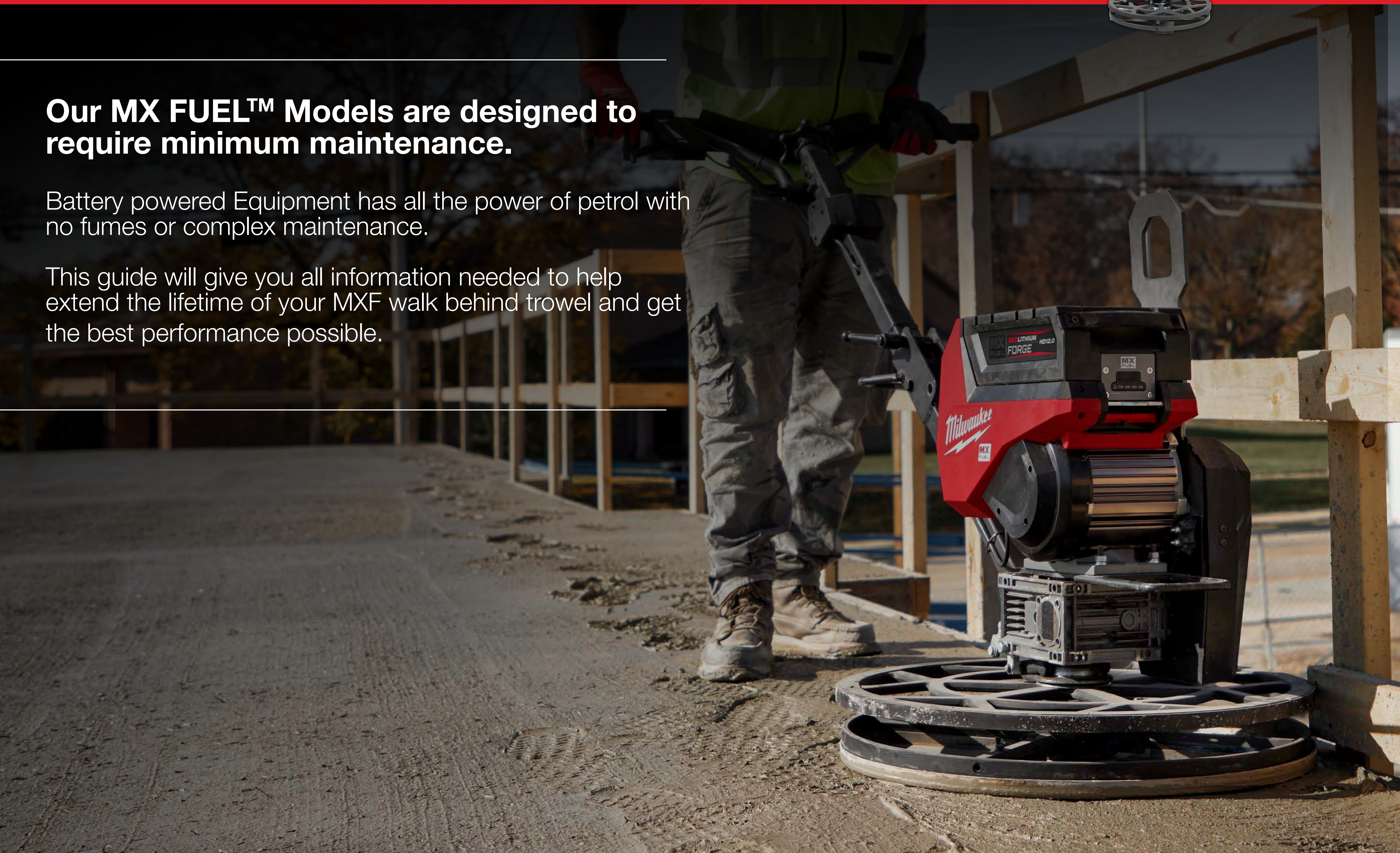





MXF WBT60

To keep your walk behind trowel in the best working condition, follow the listed steps within the maintenance schedule.

For any action, make sure to respect the safety instructions written in the manual to protect yourself and the device.

## SCHEDULE

CHECKLIST	DAILY BEFORE	AFTER OPERATION
All safety devices and guards are in place and in working order.		
All controls function correctly.		
Visual inspection of all parts for damage.		
Check that all connections are tight.		
Dead-man switch operation.		
Pitch control assembly.		
Battery - visual check for damage.		
Battery charger - visual check for damage.		
Clean the machine and blade.		
Clean the battery.		

	FREQUENCY
Lubricate pitch control.	Every 1 month or 50 hours
Check drive belt.	Every 3 months or 100 hours
Check blade arms.	Every 3 months or 100 hours
Check gearbox oil level.	Every 3 months or 100 hours
Replace drive belt.	Every 12 months or 300 hours
Lubricate blade arms.	Every 12 months or 400 hours







**MXF WBT60**

**To make sure your walk behind trowel is working properly and to extend its lifetime, cleaning on a regular basis is a mandatory process.**

**Cleaning your tool just takes a few minutes after a casual use.**

Allow the engine to cool down before cleaning and remove the battery.  
Please respect the safety advice written within the manual.

- Do not allow concrete to harden on the machine. Wipe all concrete off the frame and any other parts of the machine.
- Remove the battery before cleaning the tool.
- Allow the engine to cool down before cleaning. When the engine has cooled, remove all concrete and foreign debris using a soft brush, wiping cloth and a mild cleaning detergent.
- Do not use a high pressure water jet.
- Avoid getting water inside the motor, battery compartment, electronics housing or into the on/off switch on the handle.
- If you are not going to use the machine for a long period of time, allow it to dry thoroughly and store it in a clean, dry and dust-free place.

**CLEANING**







**MXF WBT60**

Make sure to be safe and respect the instructions written within the manual and the local regulations.

## CHANGING THE V BELT

- 1. Unscrew the cover**
- 2. Remove the cover**
- 3. Insert a 9,5 mm key**
- 4. Turn the key downwards to release the pressure of the tensioner**

- 5. Remove the belt**
- 6. Put in the new belt**
- 7. Put the cover back on**
- 8. Tighten the screws with 4,5-5 Nm**

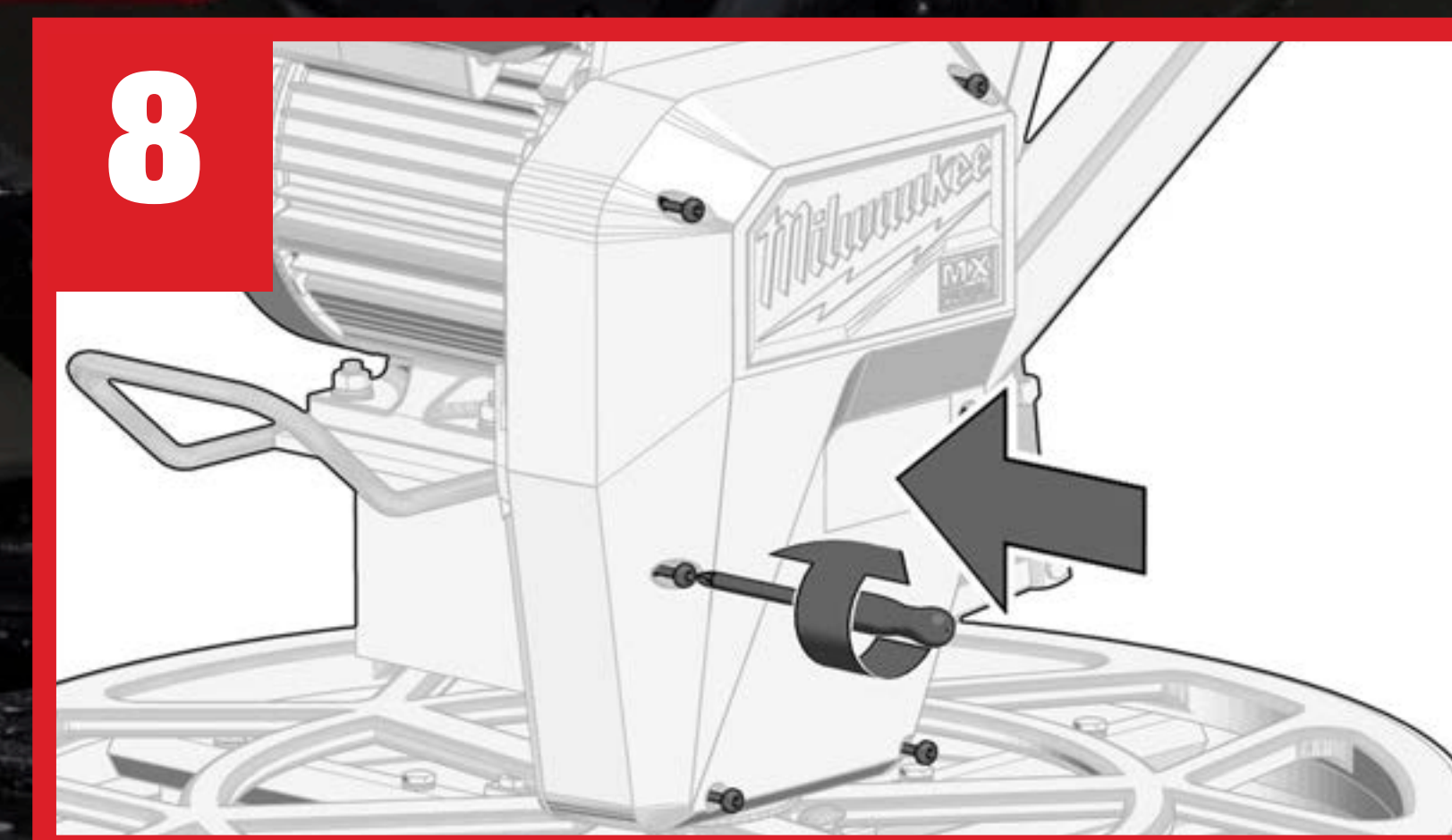
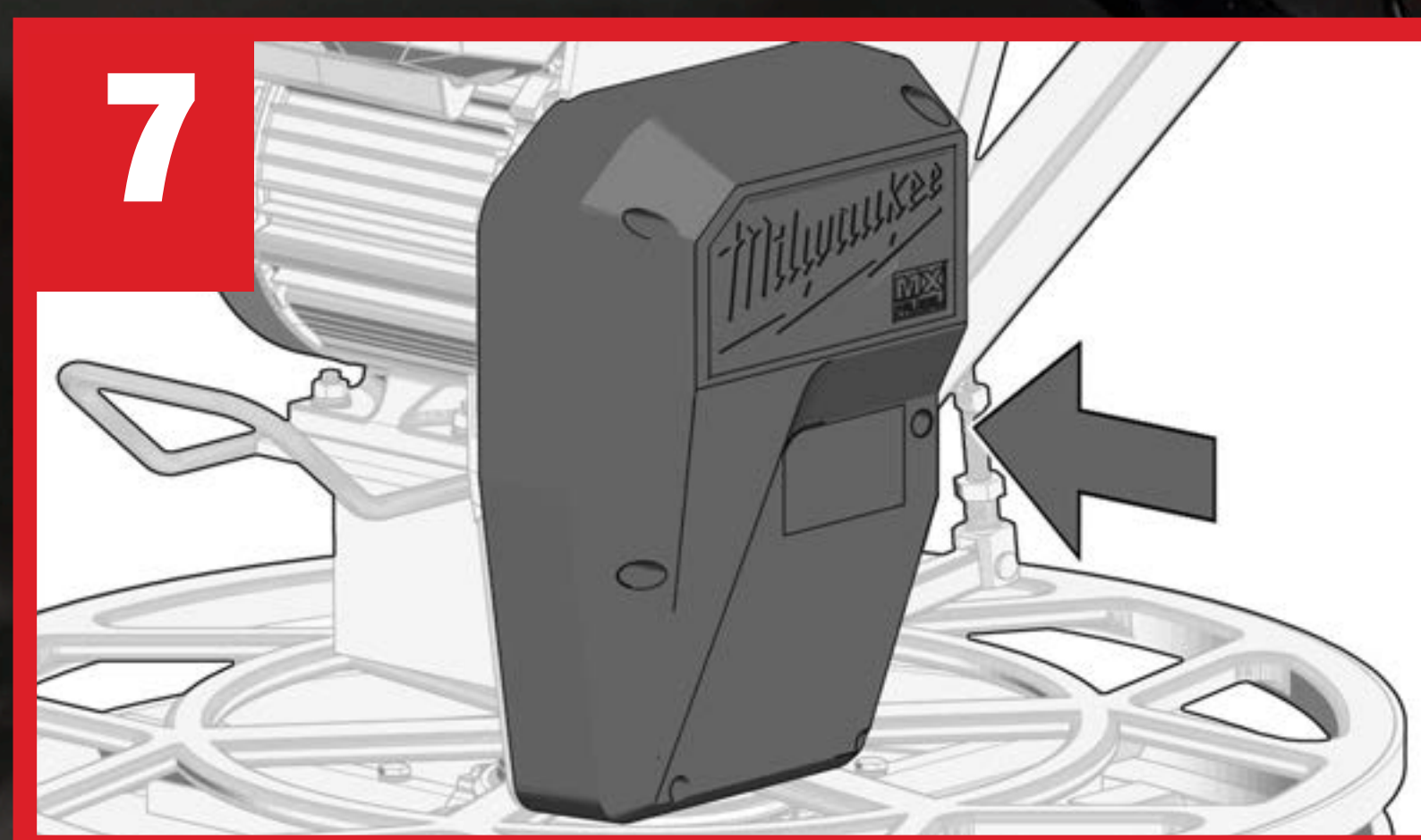
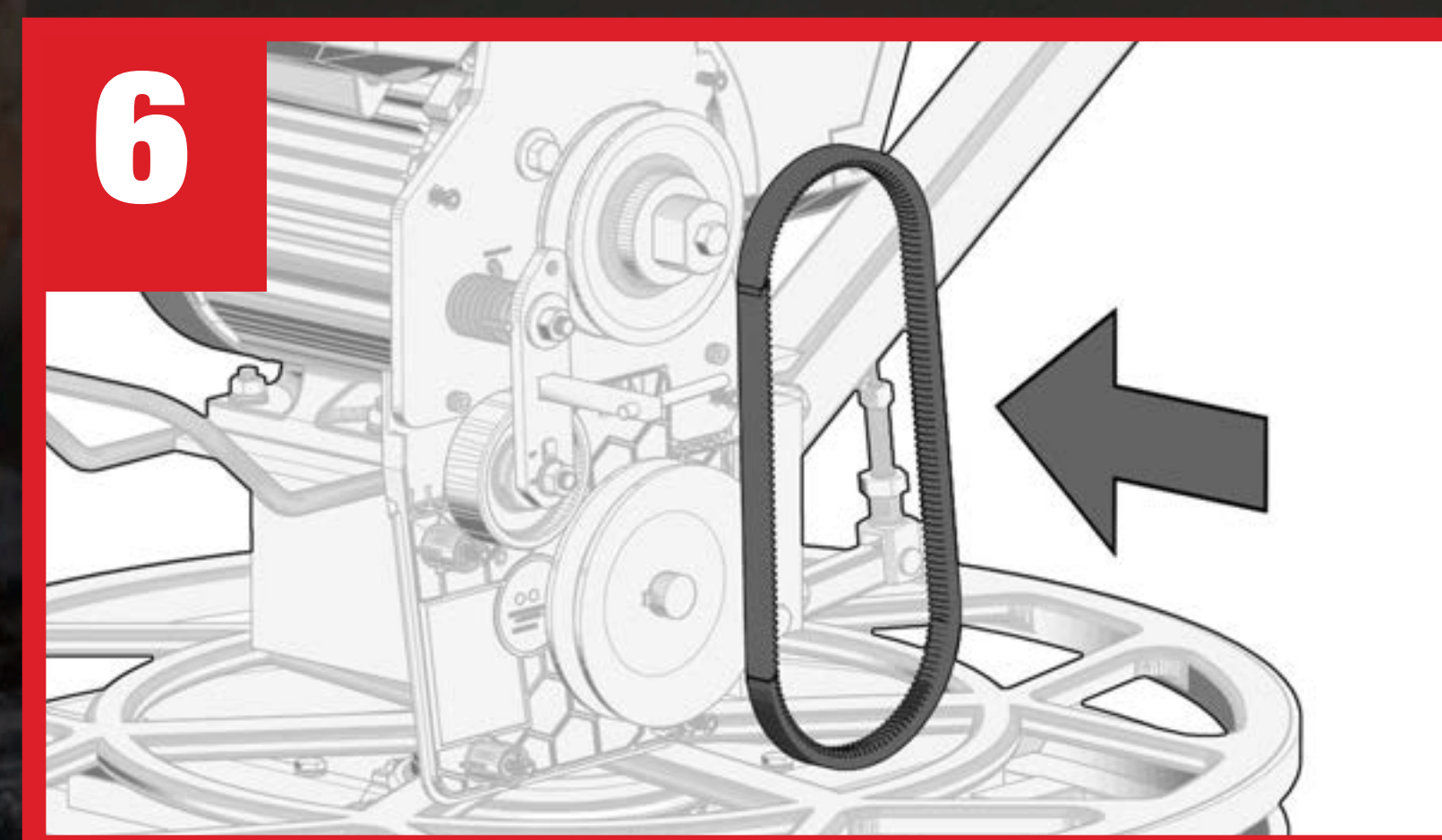
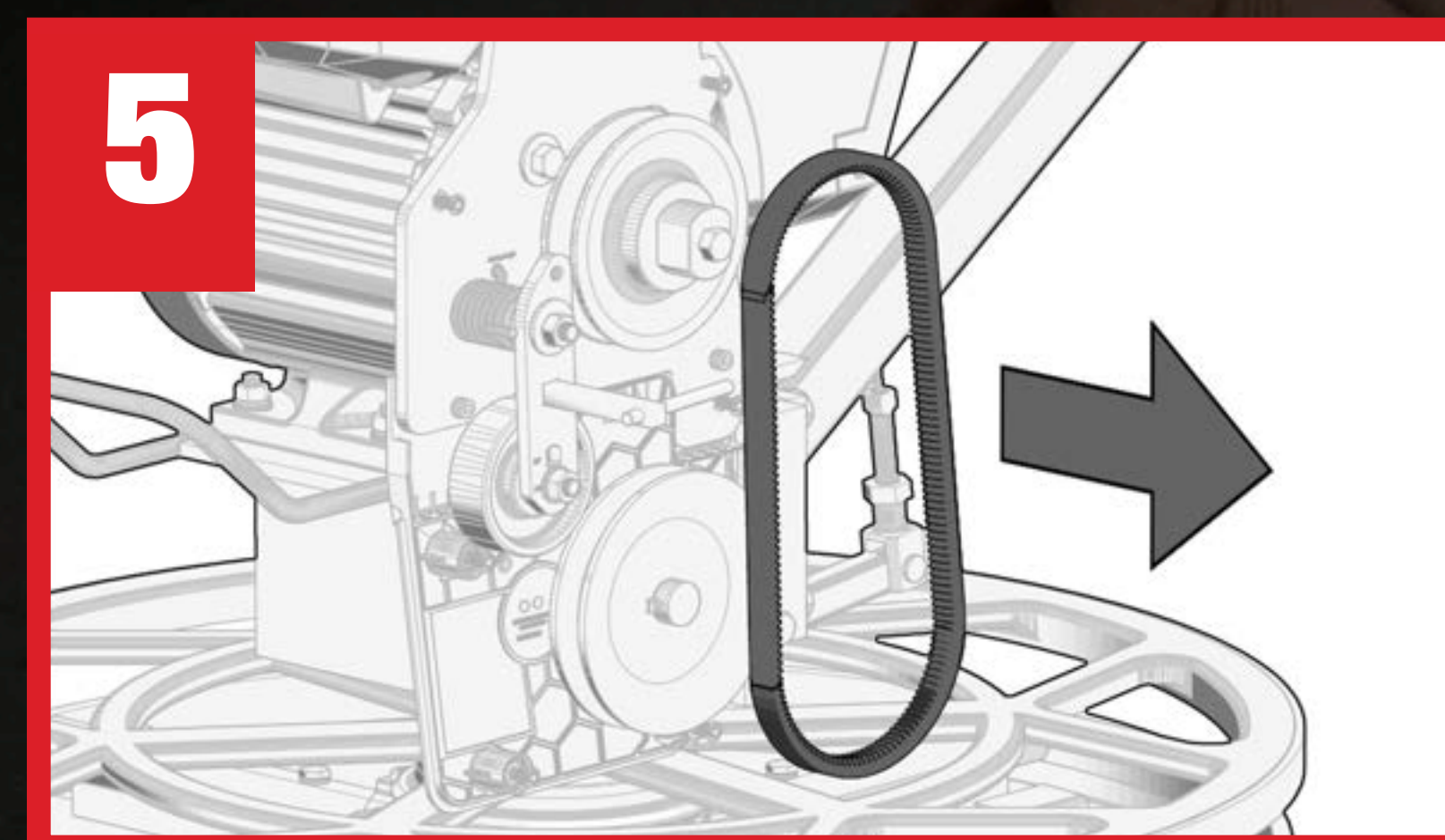
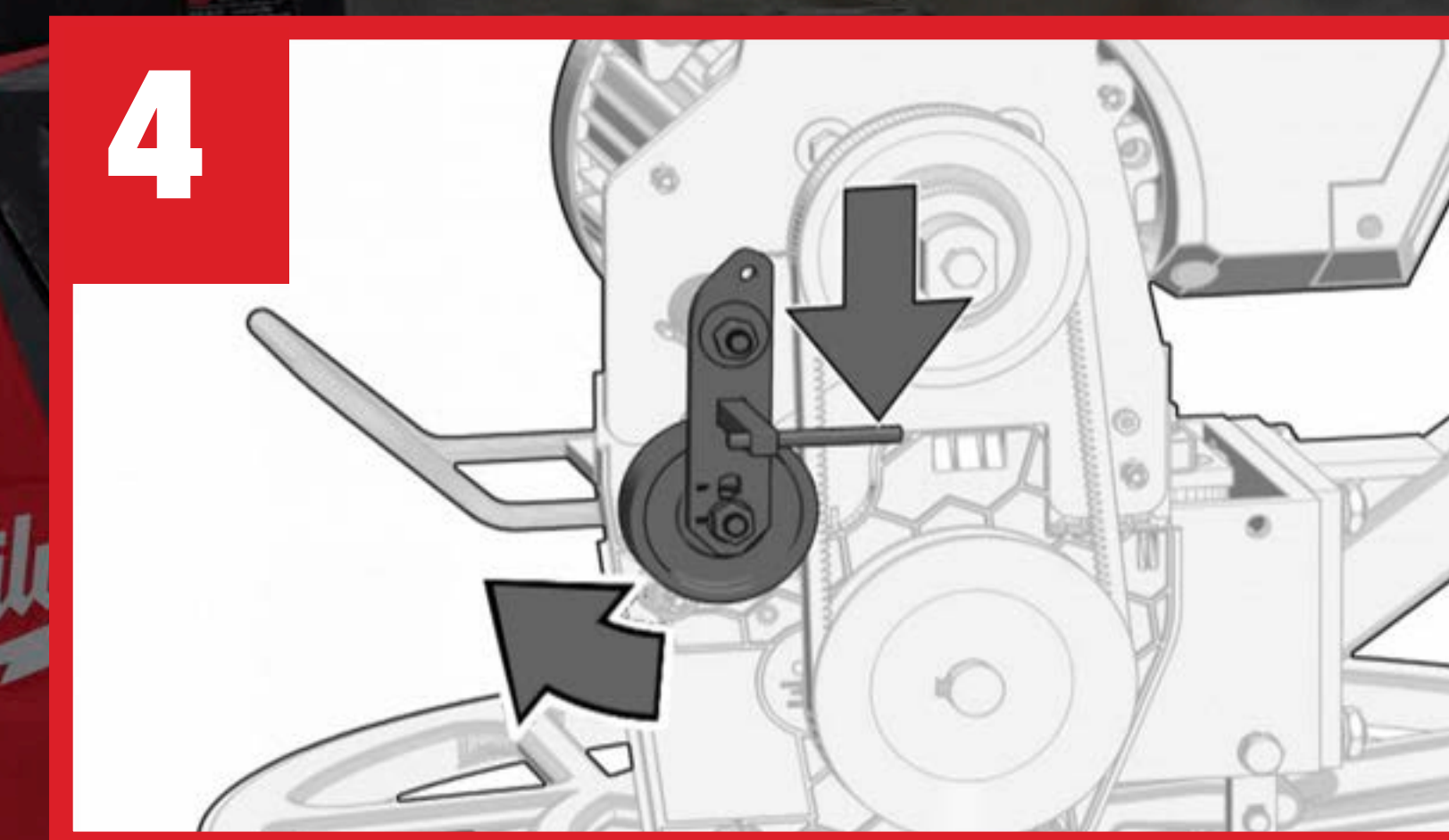
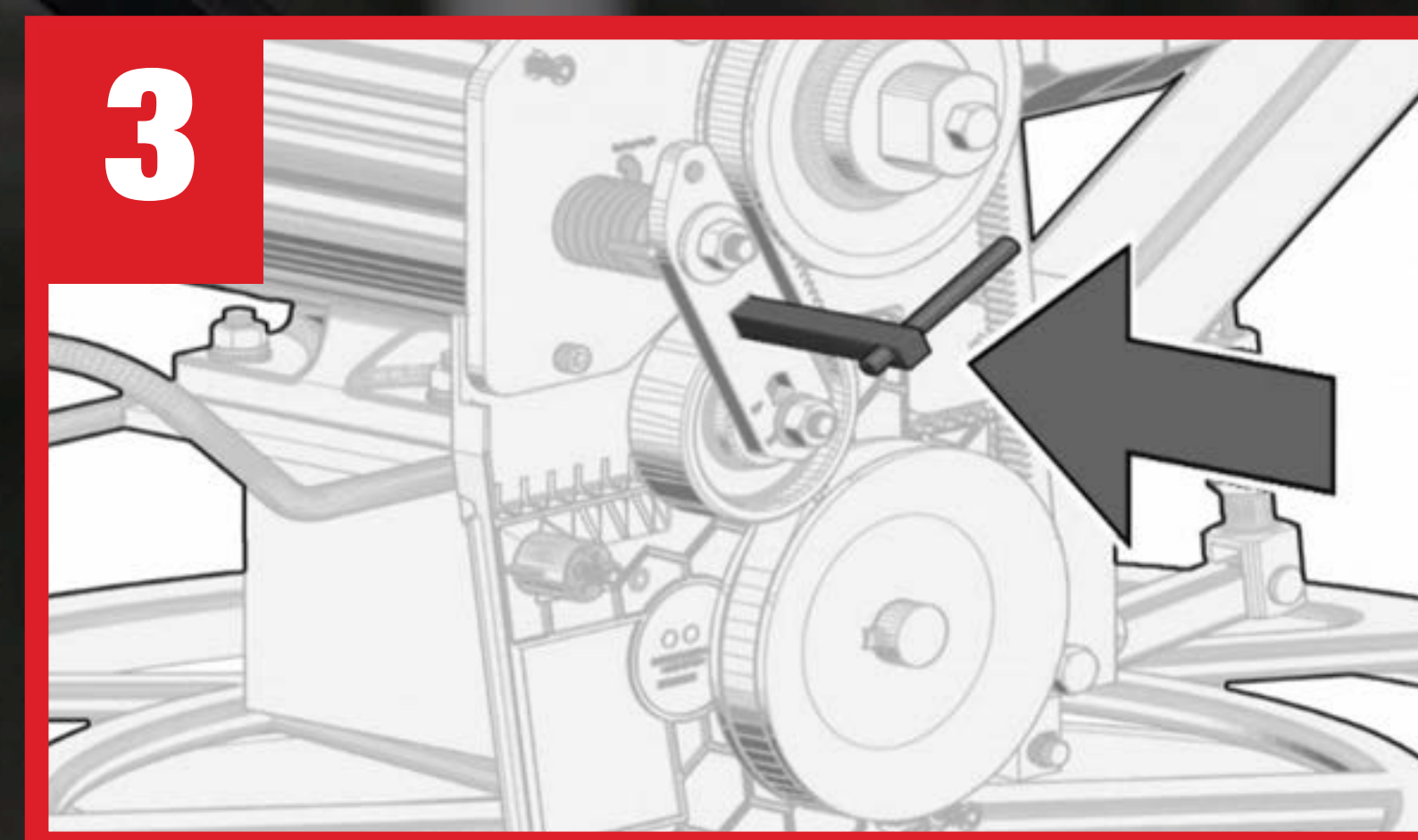
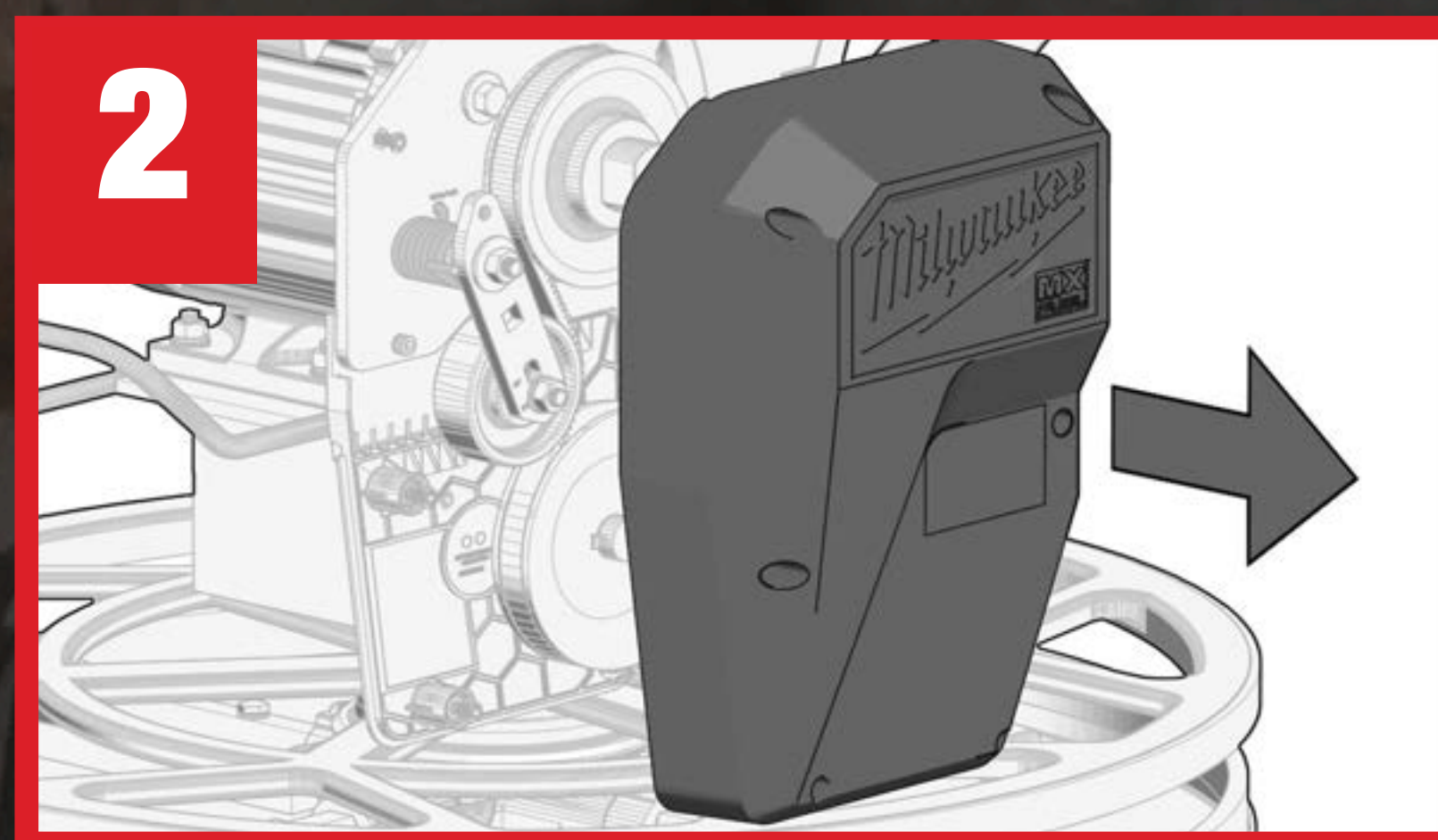
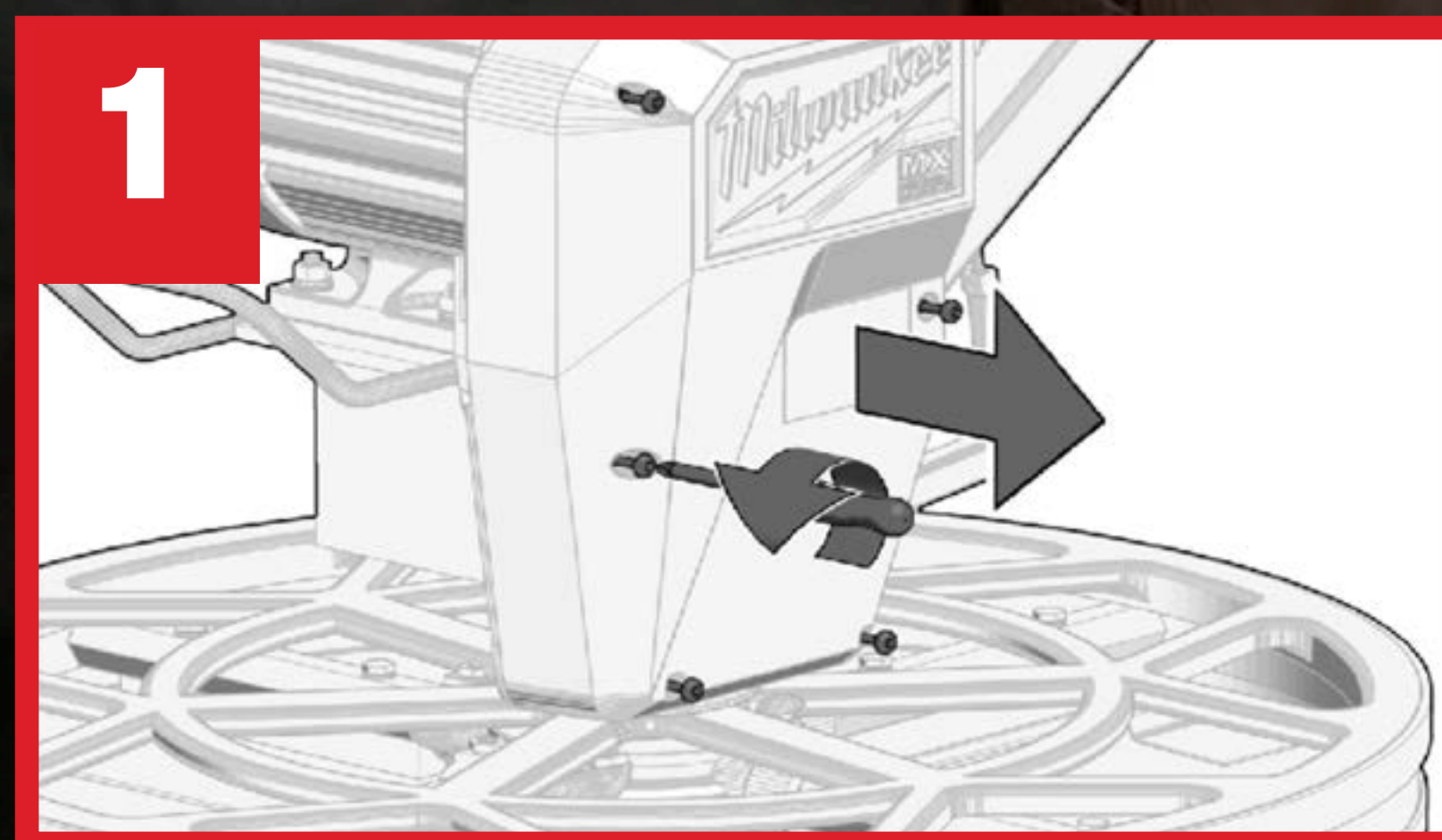





**MXF WBT60**

Make sure to be safe and respect the instructions written within the manual and the local regulations.

## CHANGING BLADES

- 1. Take the trowel off the pan**
- 2. Remove the screws**
- 3. Flip the trowel to the side**
- 4. Take off the blades**

- 5. Put the new blades back on**
- 6. Flip the trowel back into the working position**
- 7. Put the 8 screws back in and tighten with 9-10 Nm**
- 8. Put the trowel back on the pan**

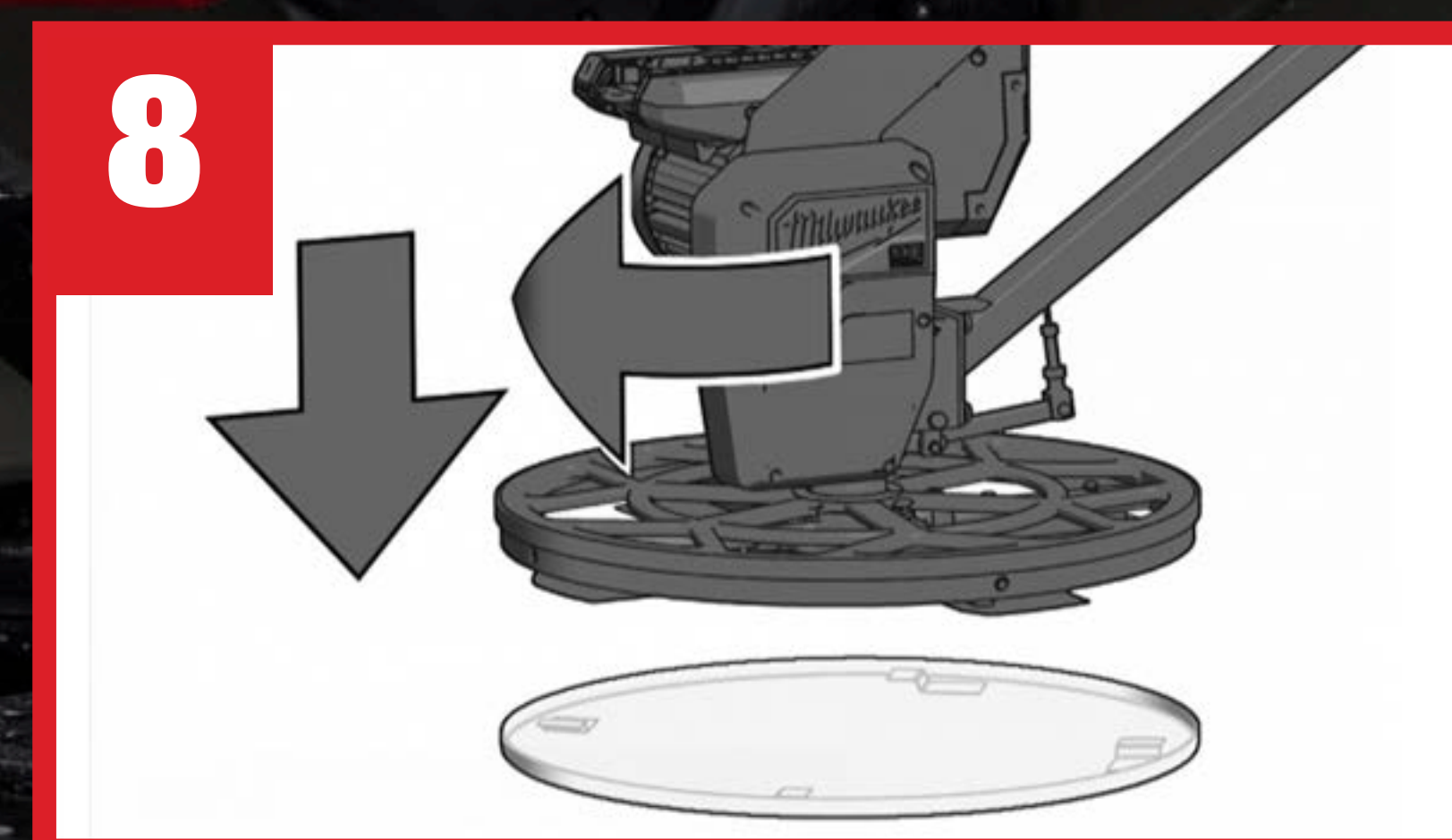
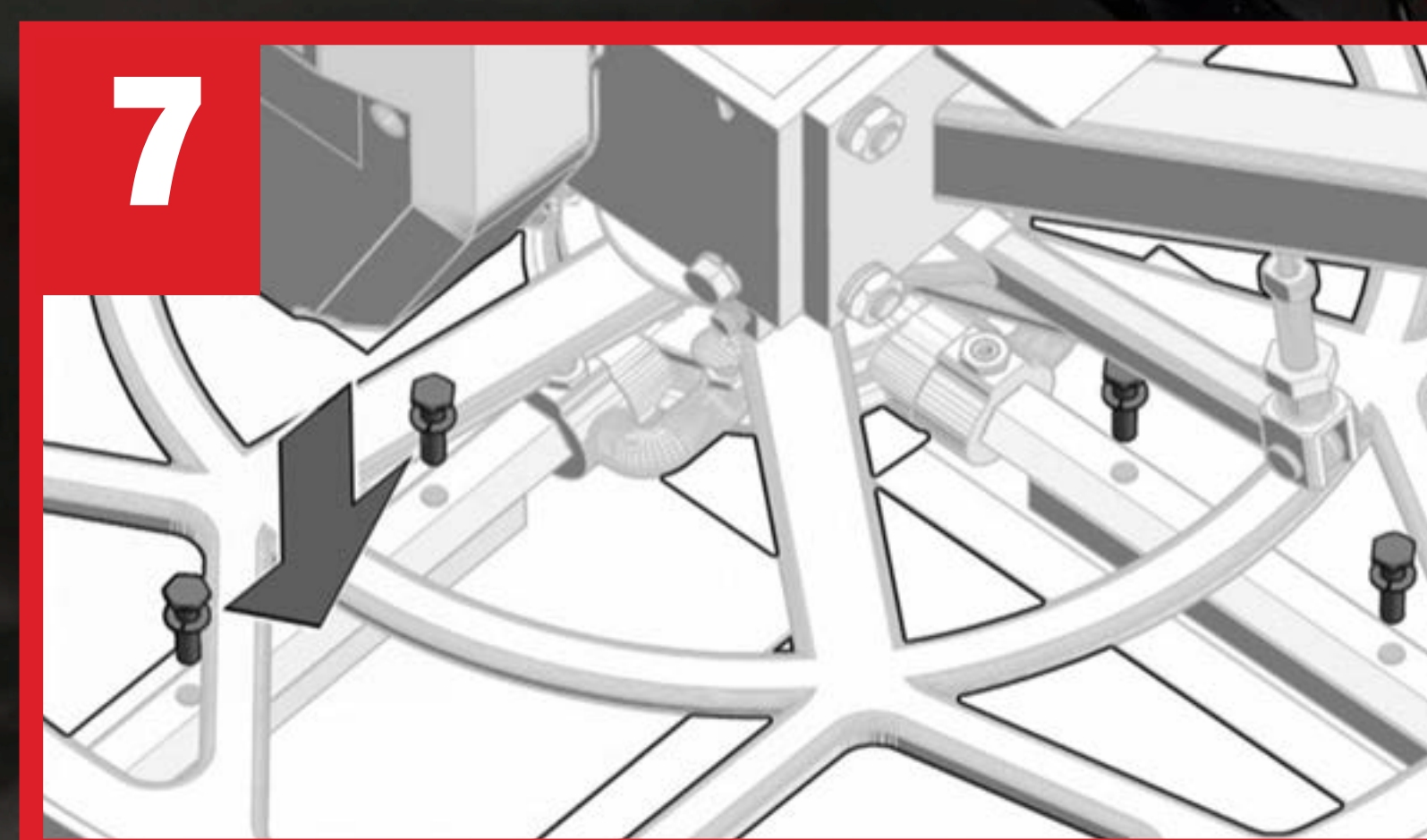
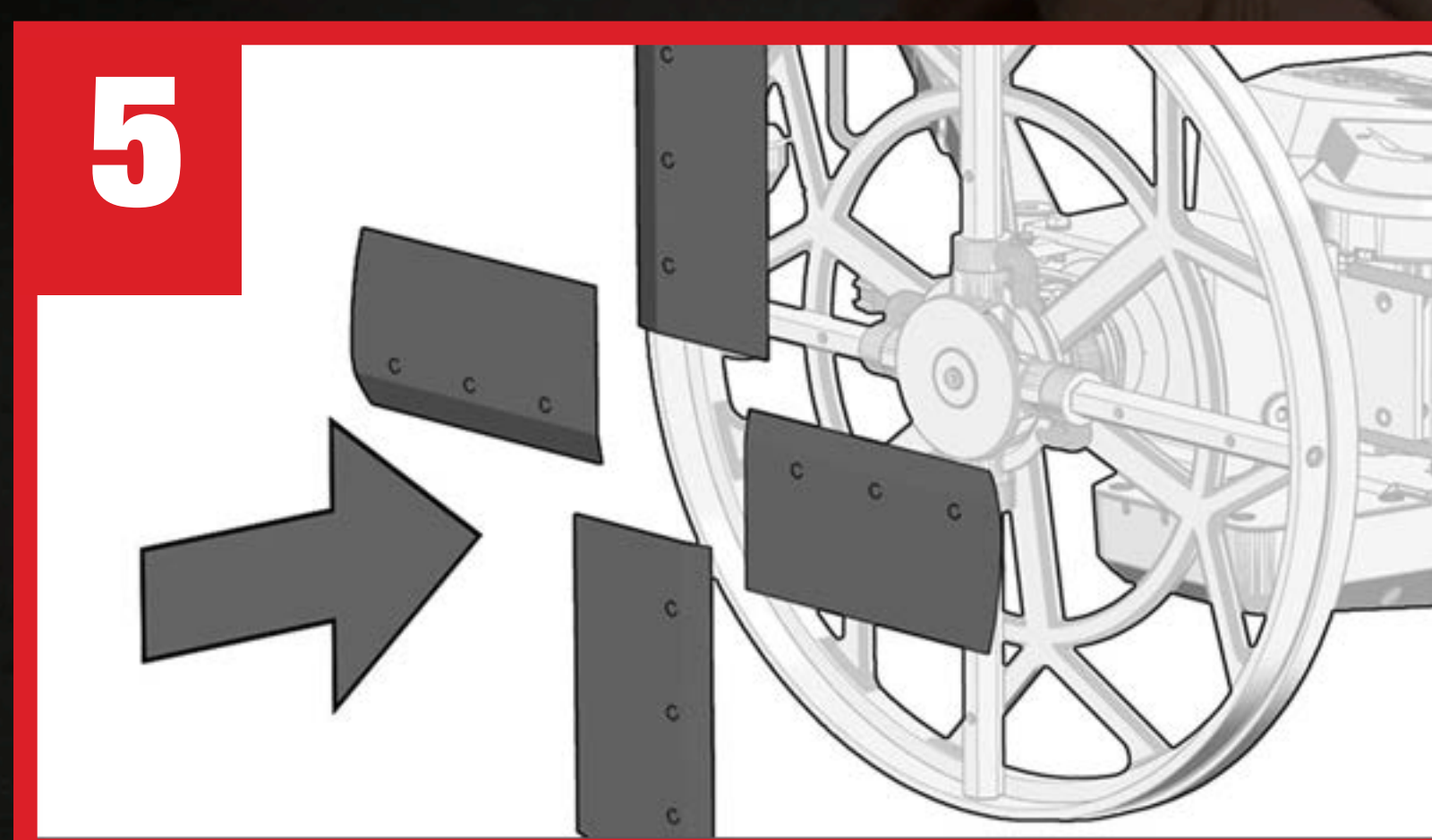
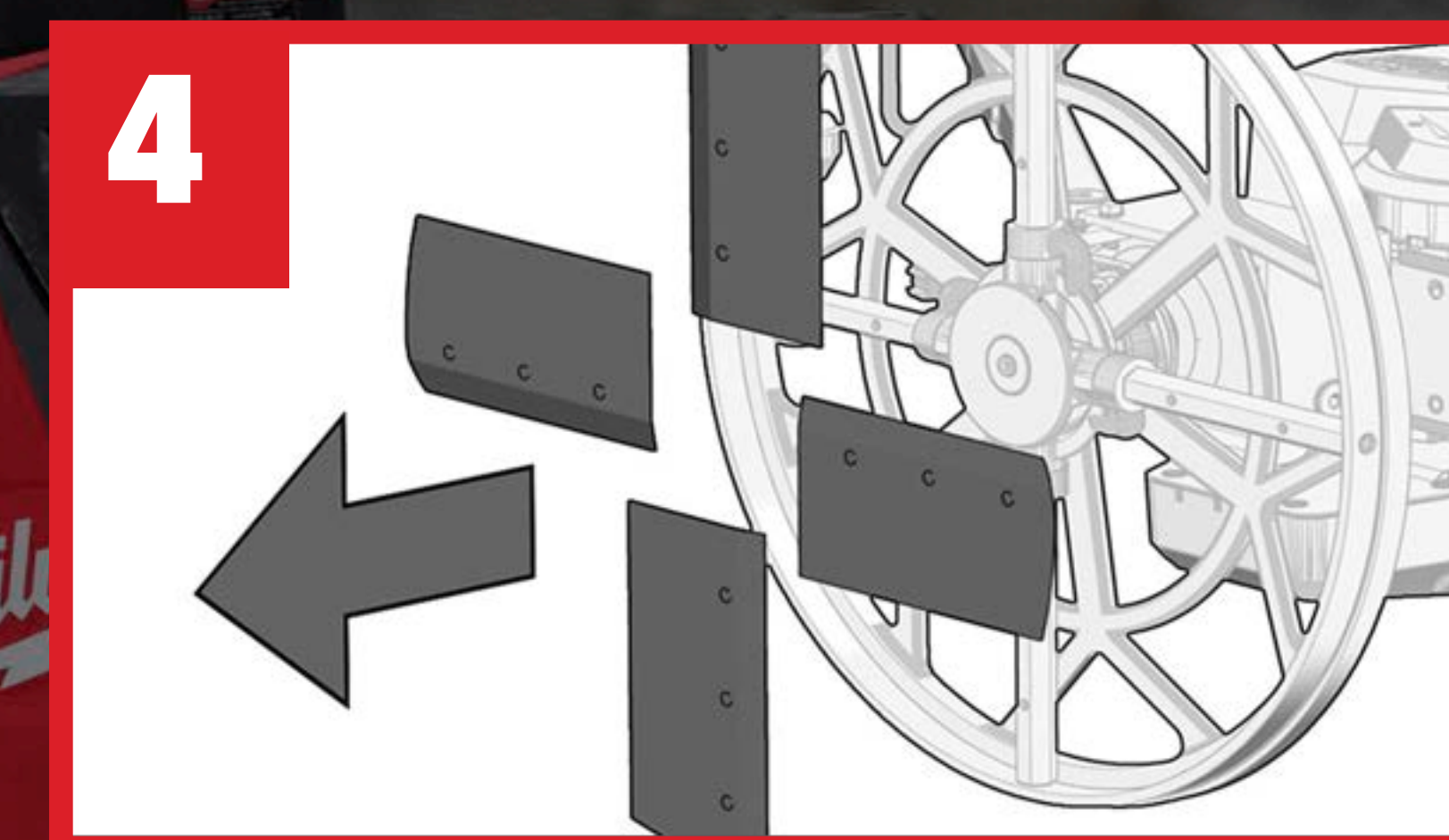
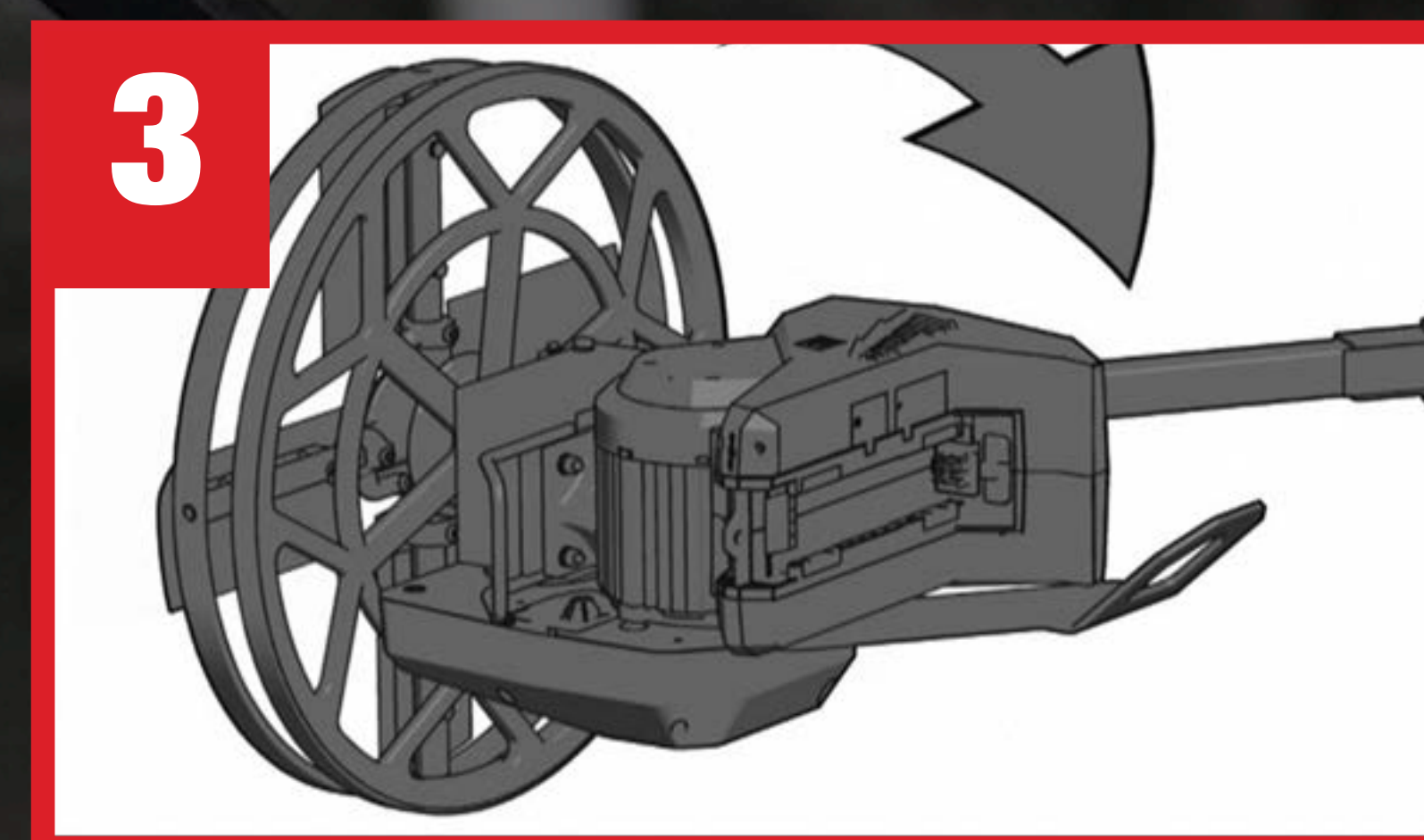
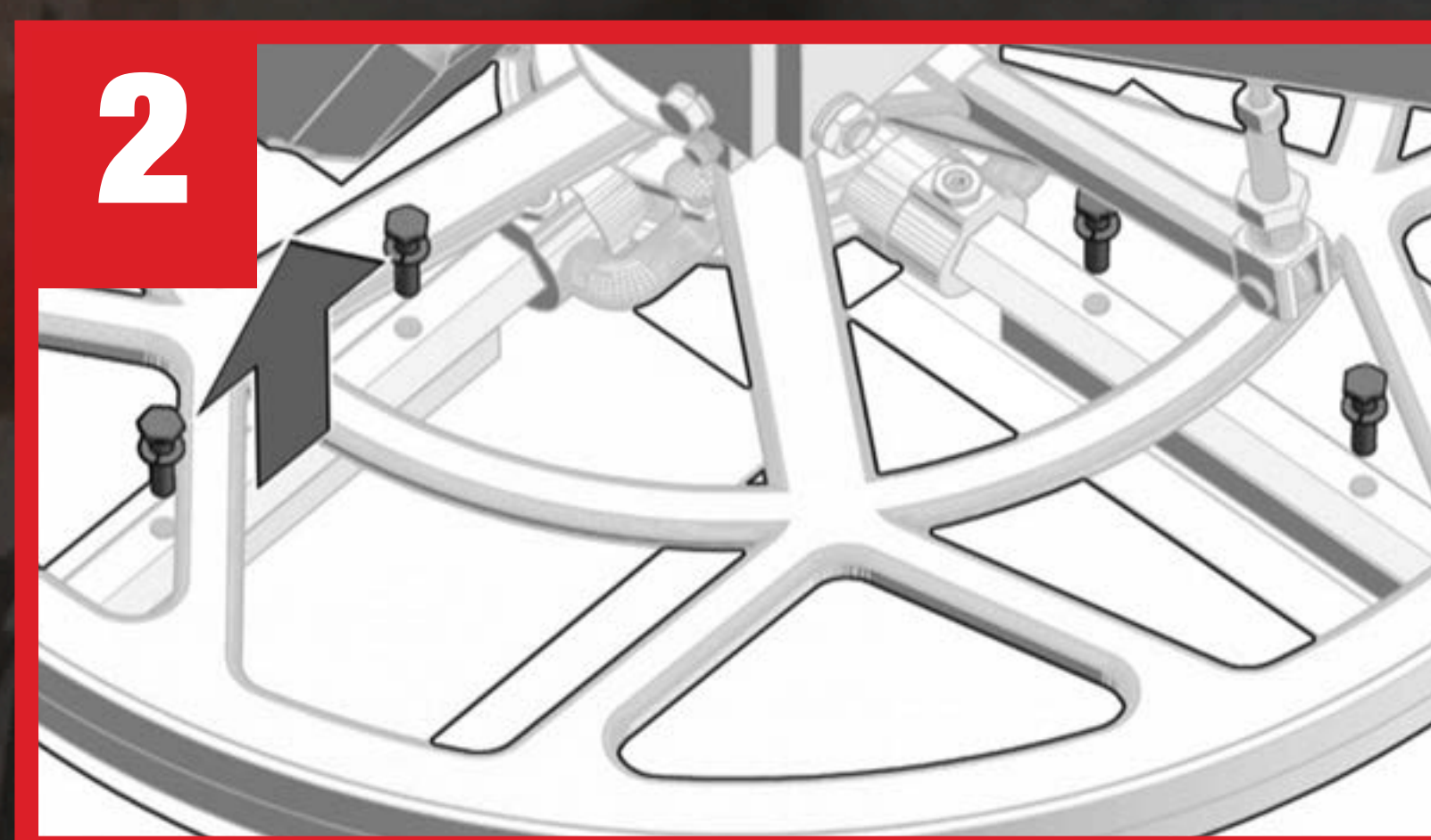
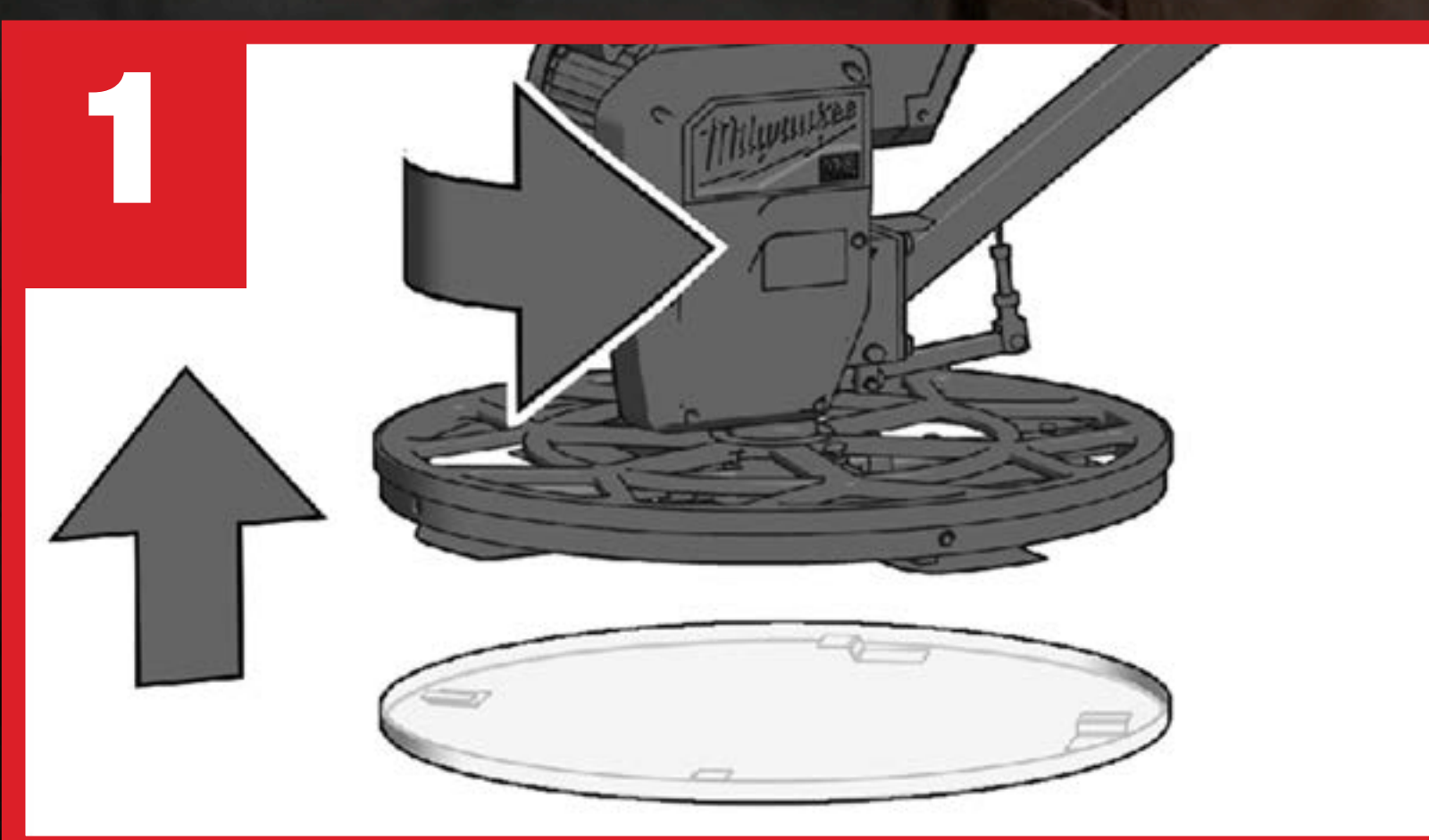





MXF WBT60

Make sure to be safe and respect the instructions written within the manual and the local regulations.

## GEARBOX OIL CHANGE

- 1. Cover the tool and make sure no oil can enter your environment**
- 2. Open the plug with an 8 mm allen key**
- 3. Tilt the machine over and drain the oil into a dedicated container ( Please ensure that you adhere the local regulations when disposing the old oil.)**
- 4. Refill the gearbox. Top up with 470-525 ml oil**
- 5. Put the plug back in with an 8 mm allen key and tighten with 12-15 Nm**

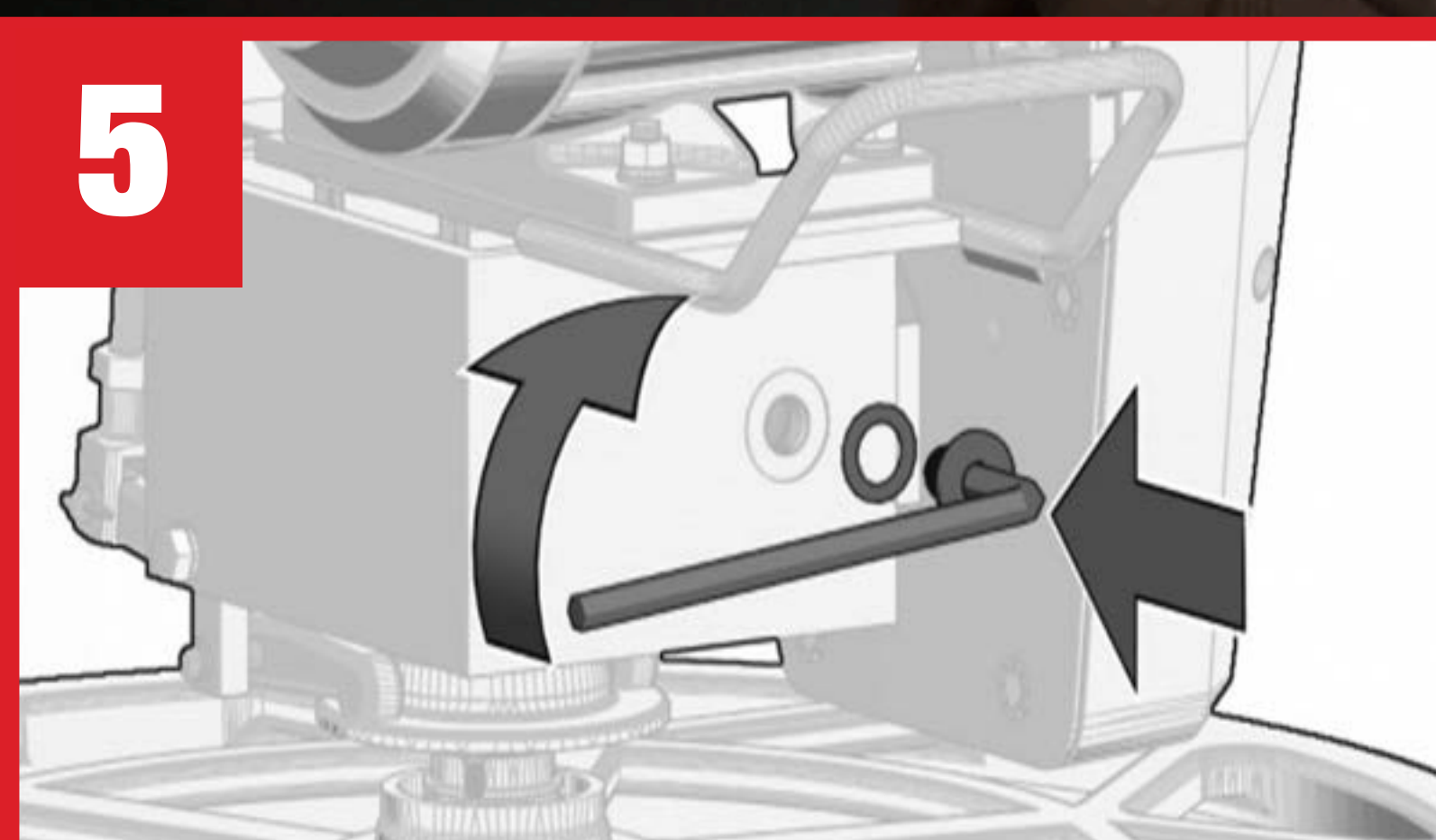
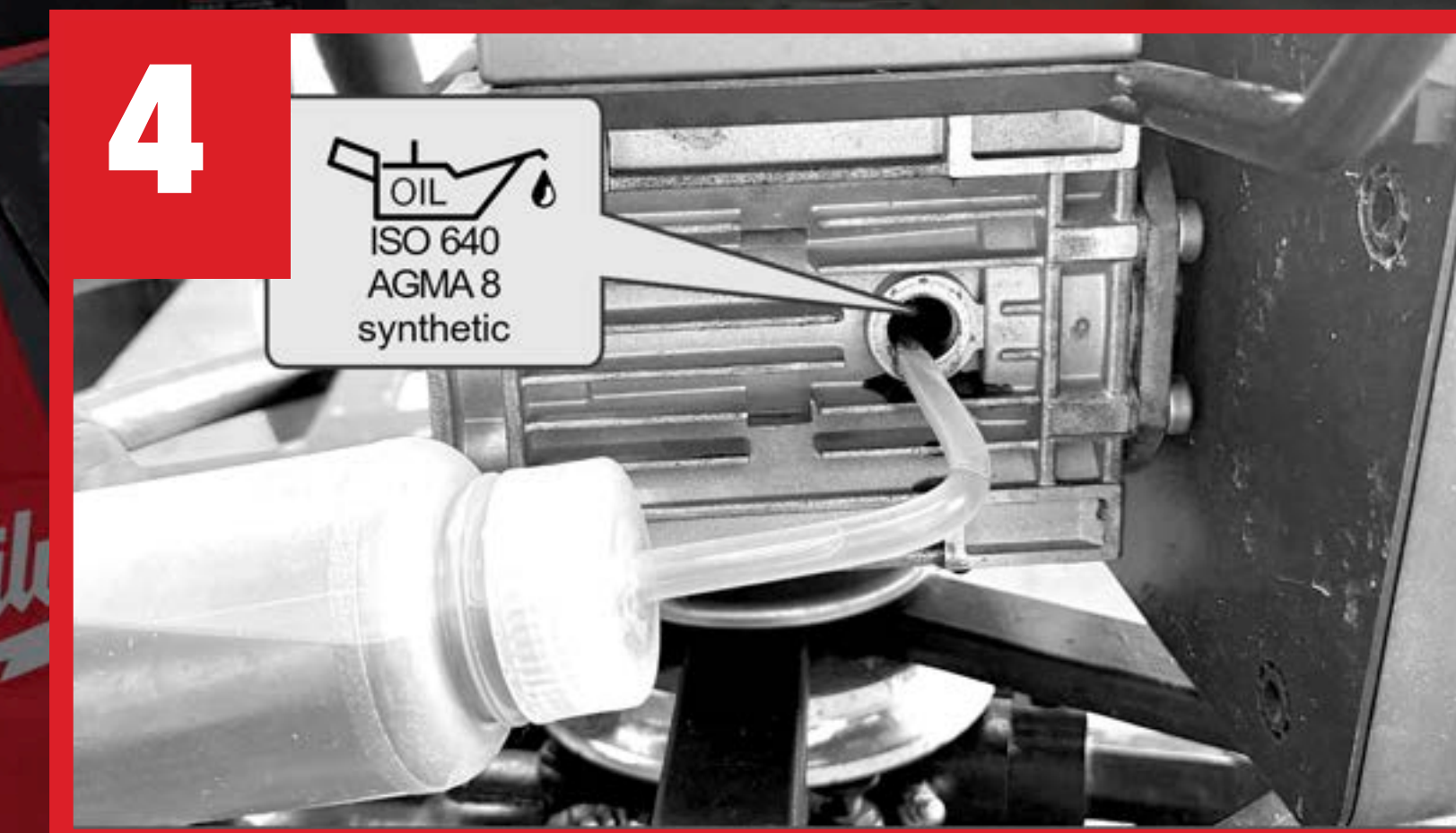
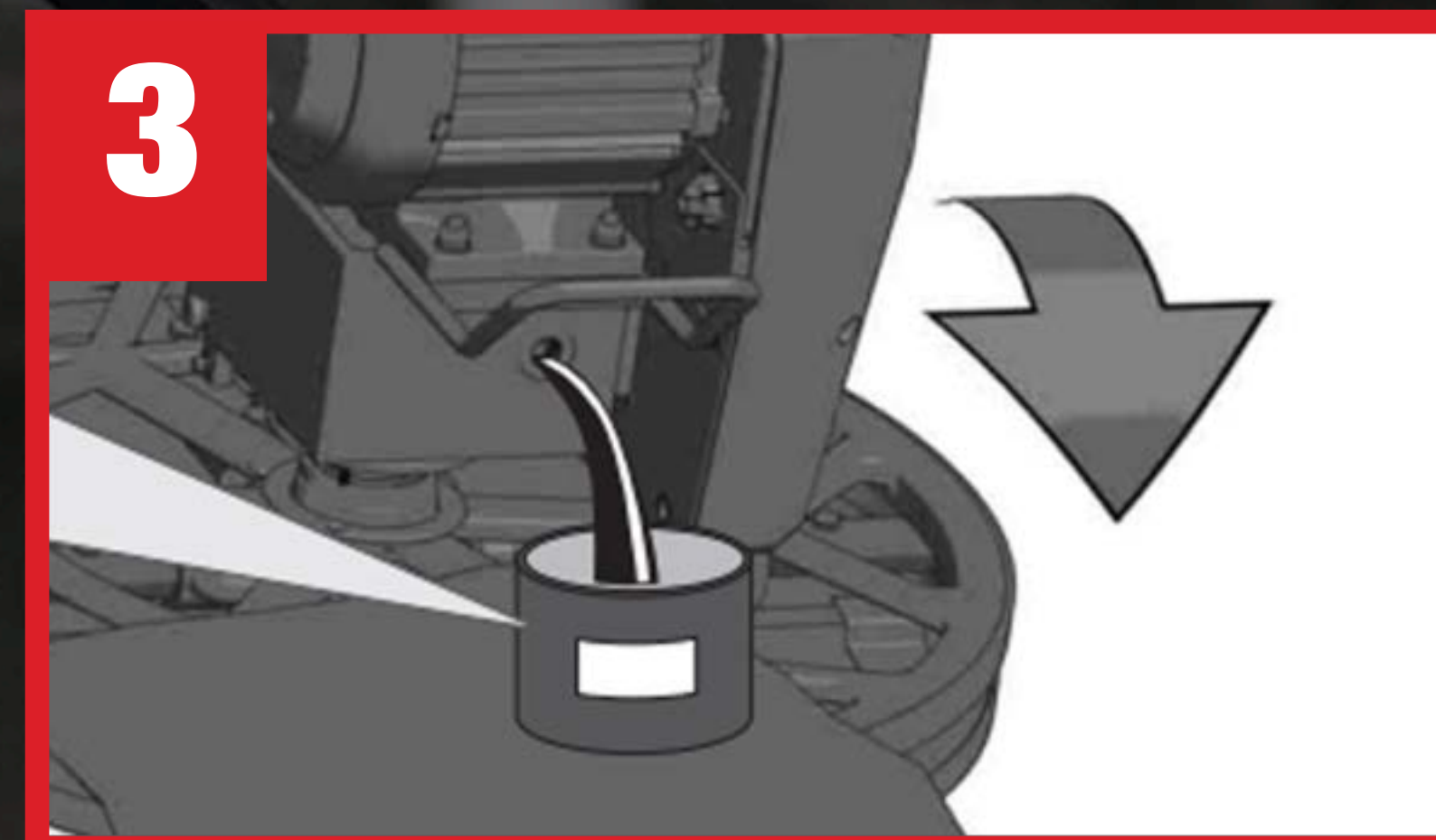
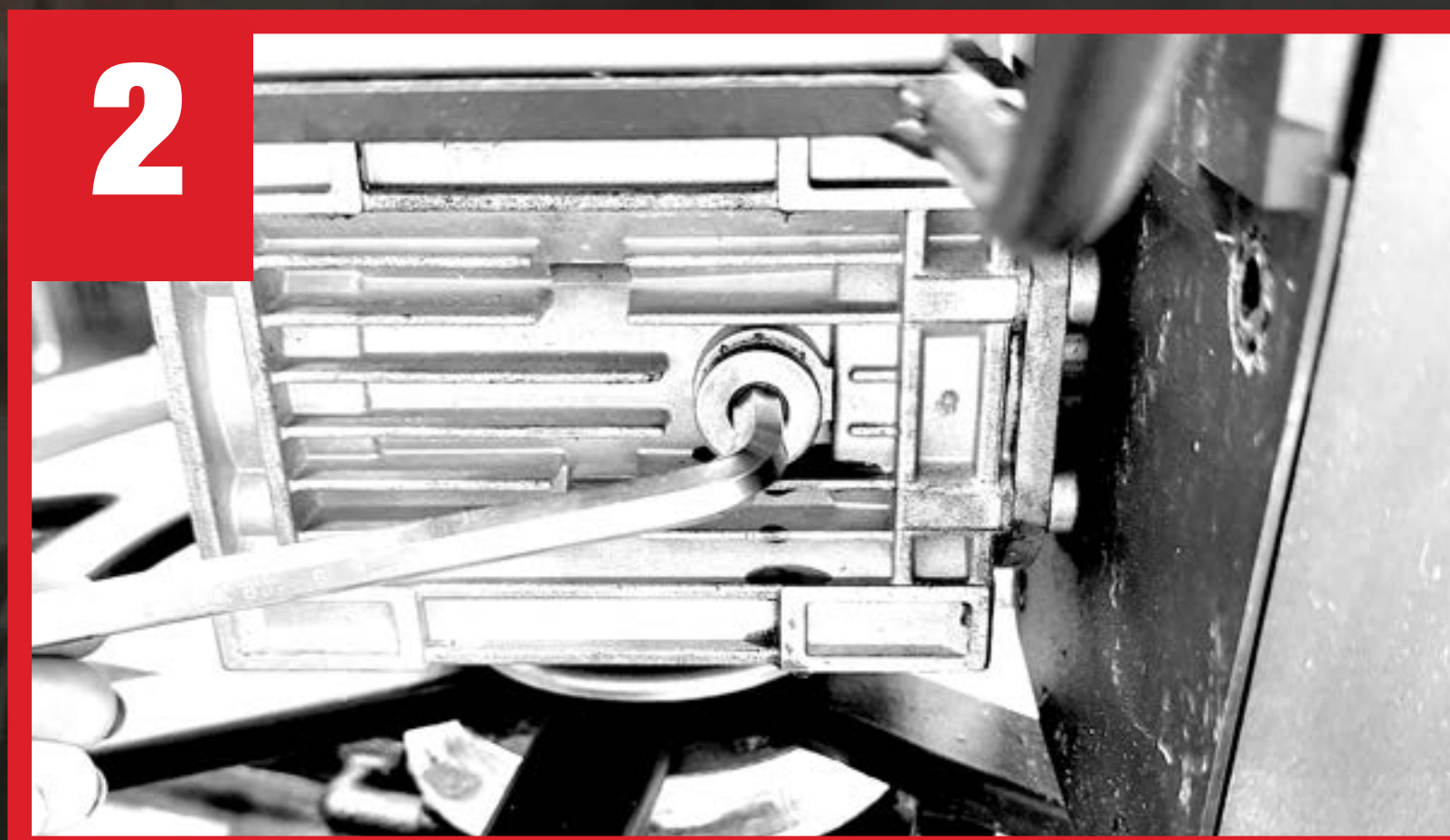
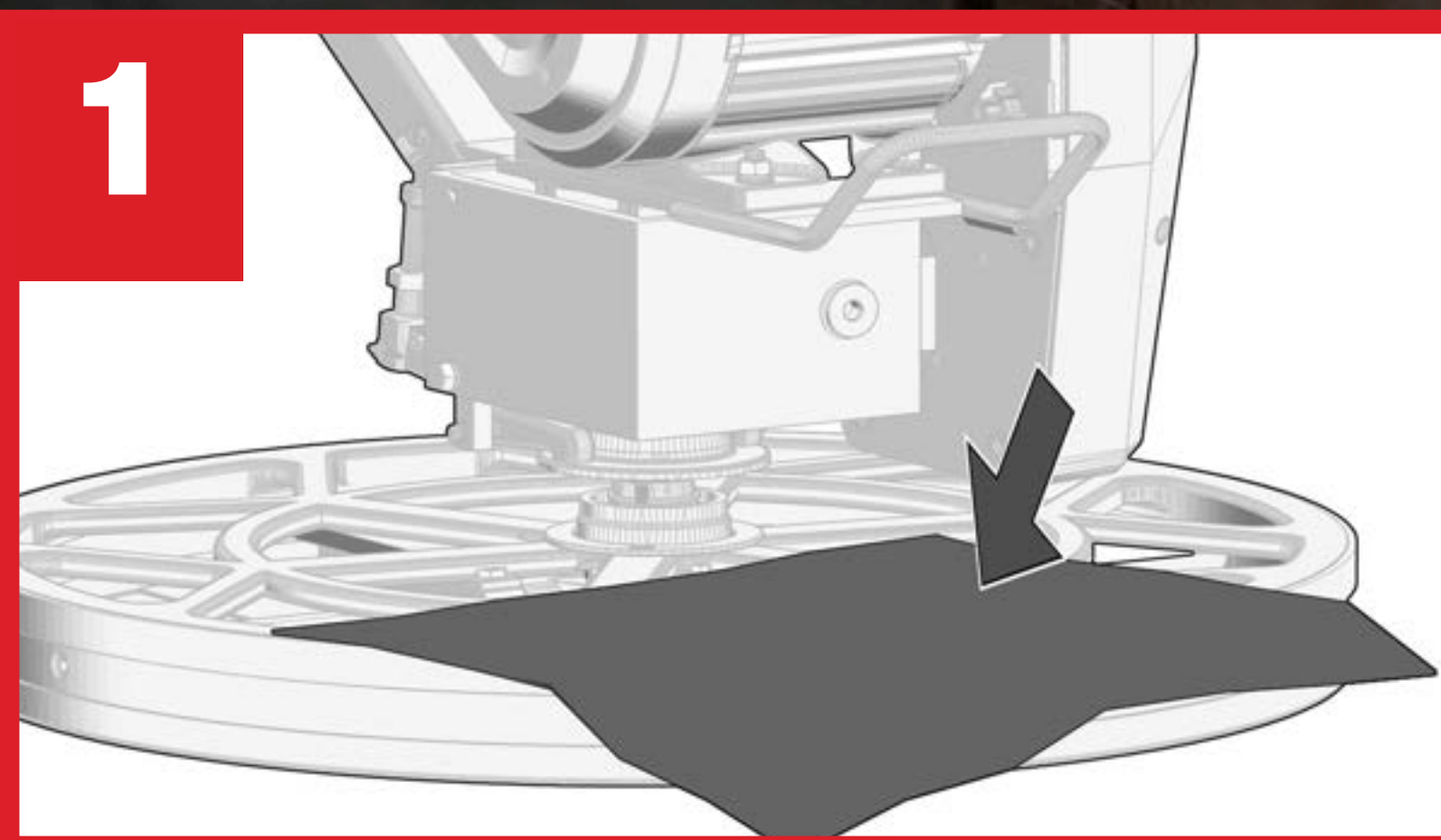





MXF WBT60

Make sure to be safe and respect the instructions written within the manual and the local regulations.

## LUBRICATION POINTS PT.1

1. Take the trowel off the pan
2. Flip the trowel to the side
3. Remove the 4 screws of the outer ring
4. Remove the Ring

5. Remove the M8 bolt with the trowel arms
6. Remove the nuts
7. Remove the worm bolts
8. Fill in 10W30 Oil

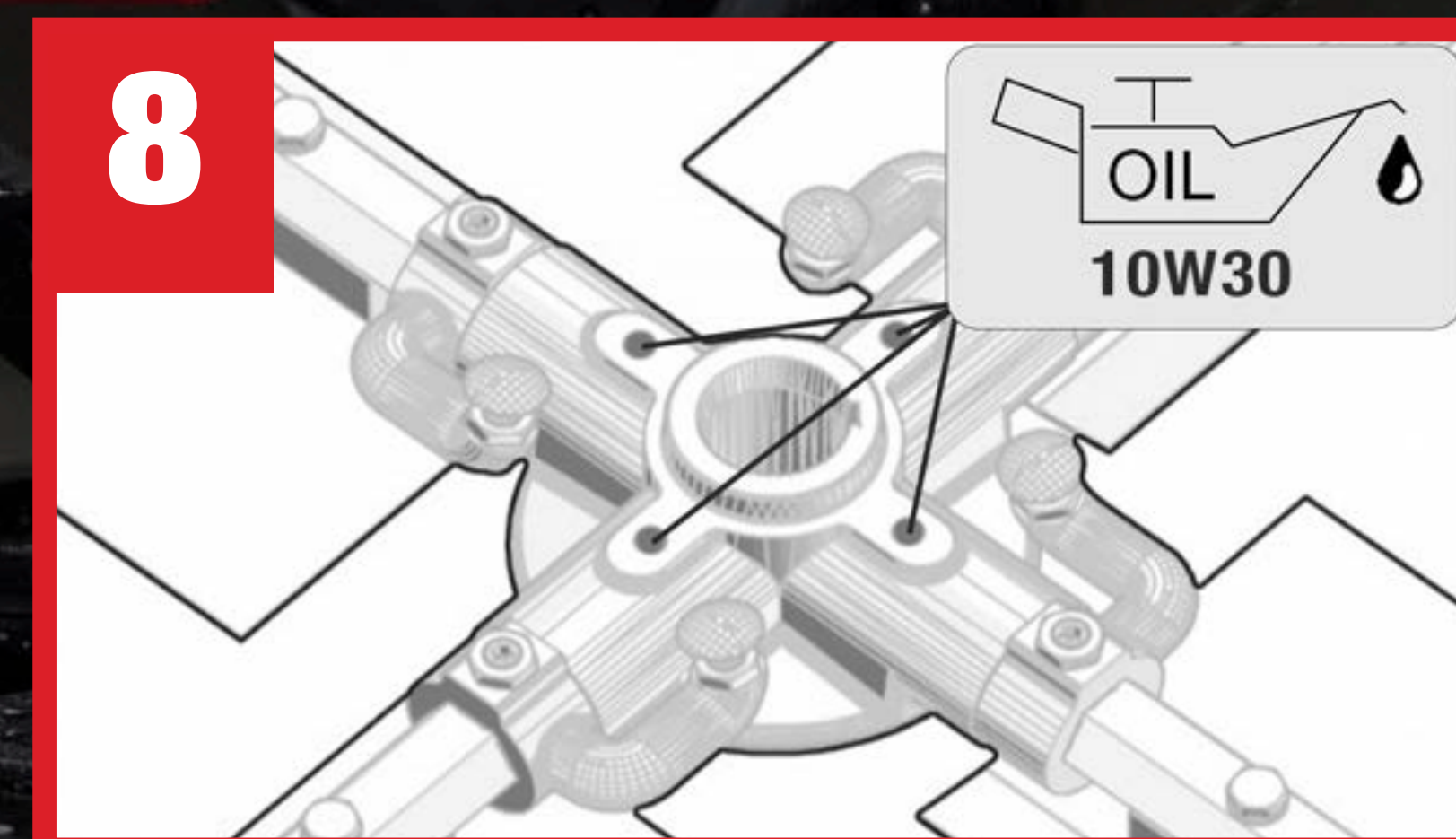
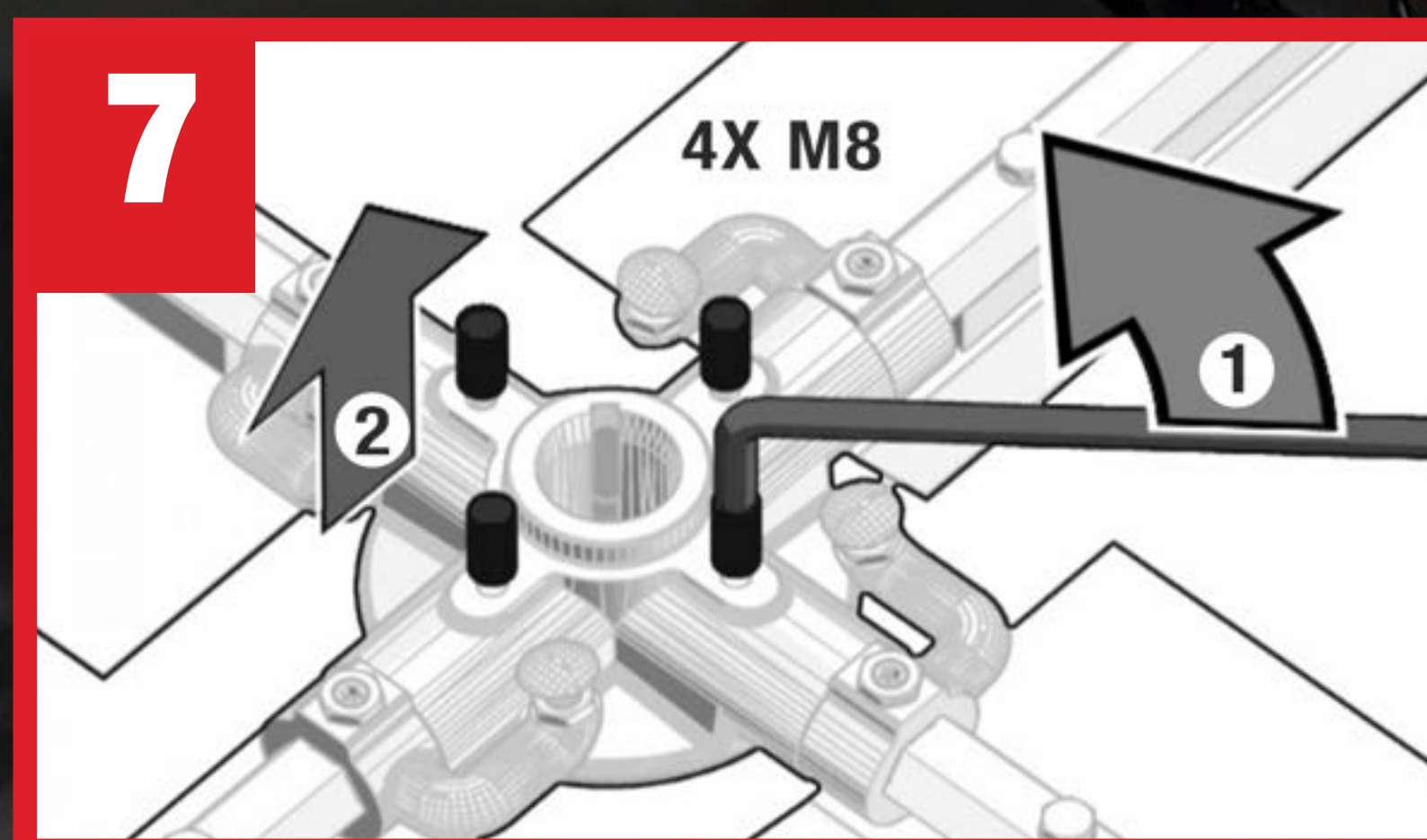
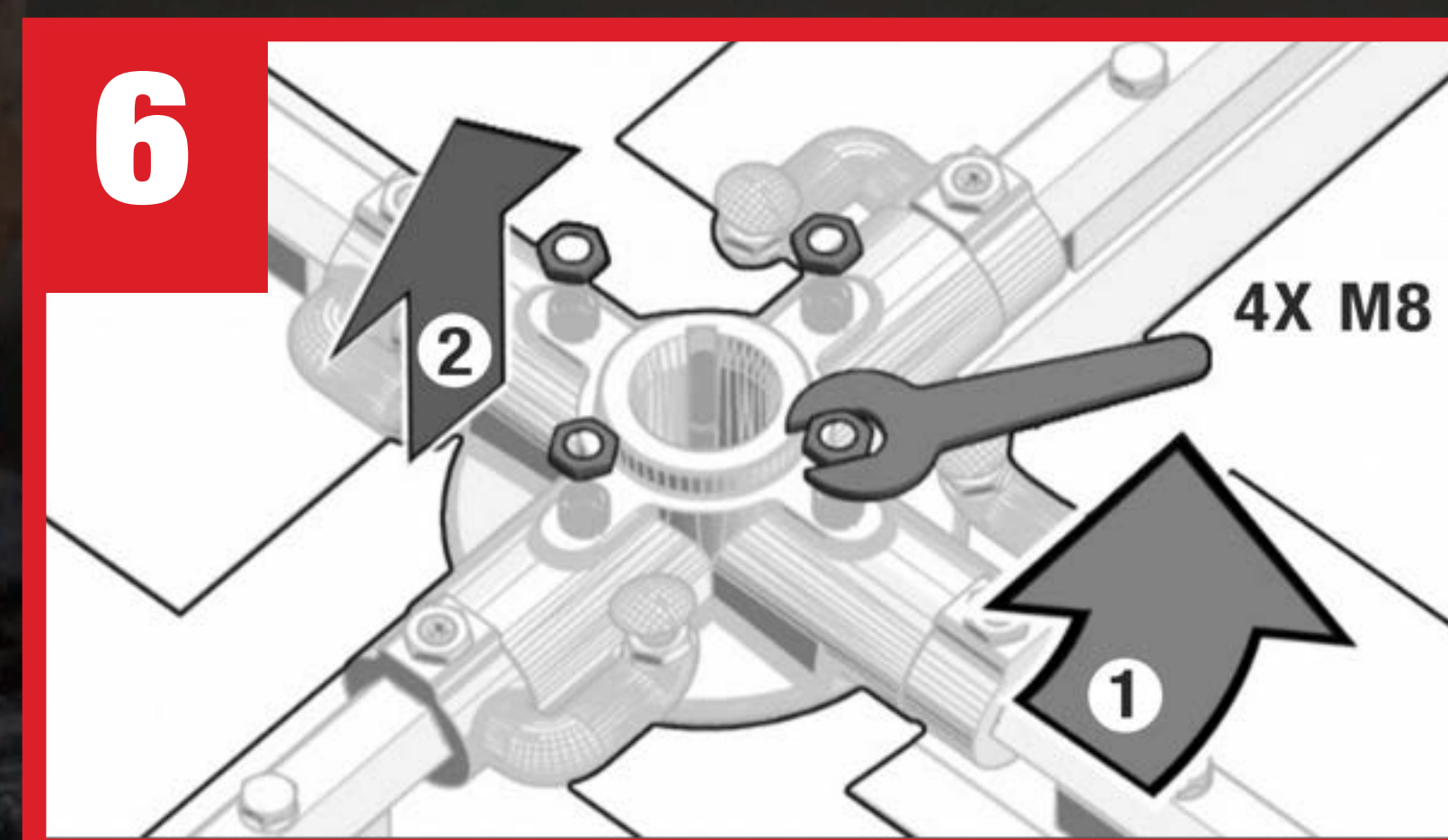
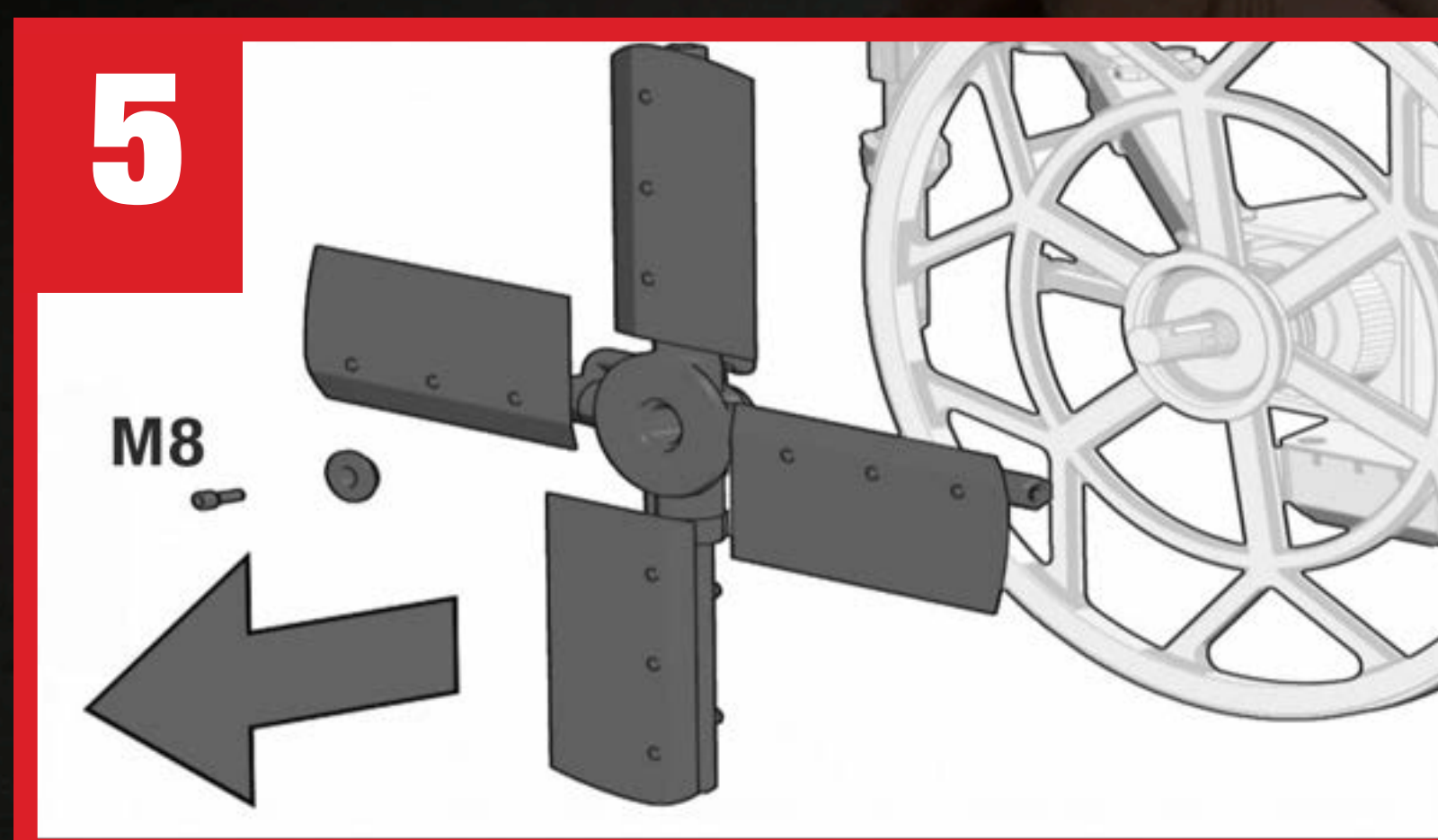
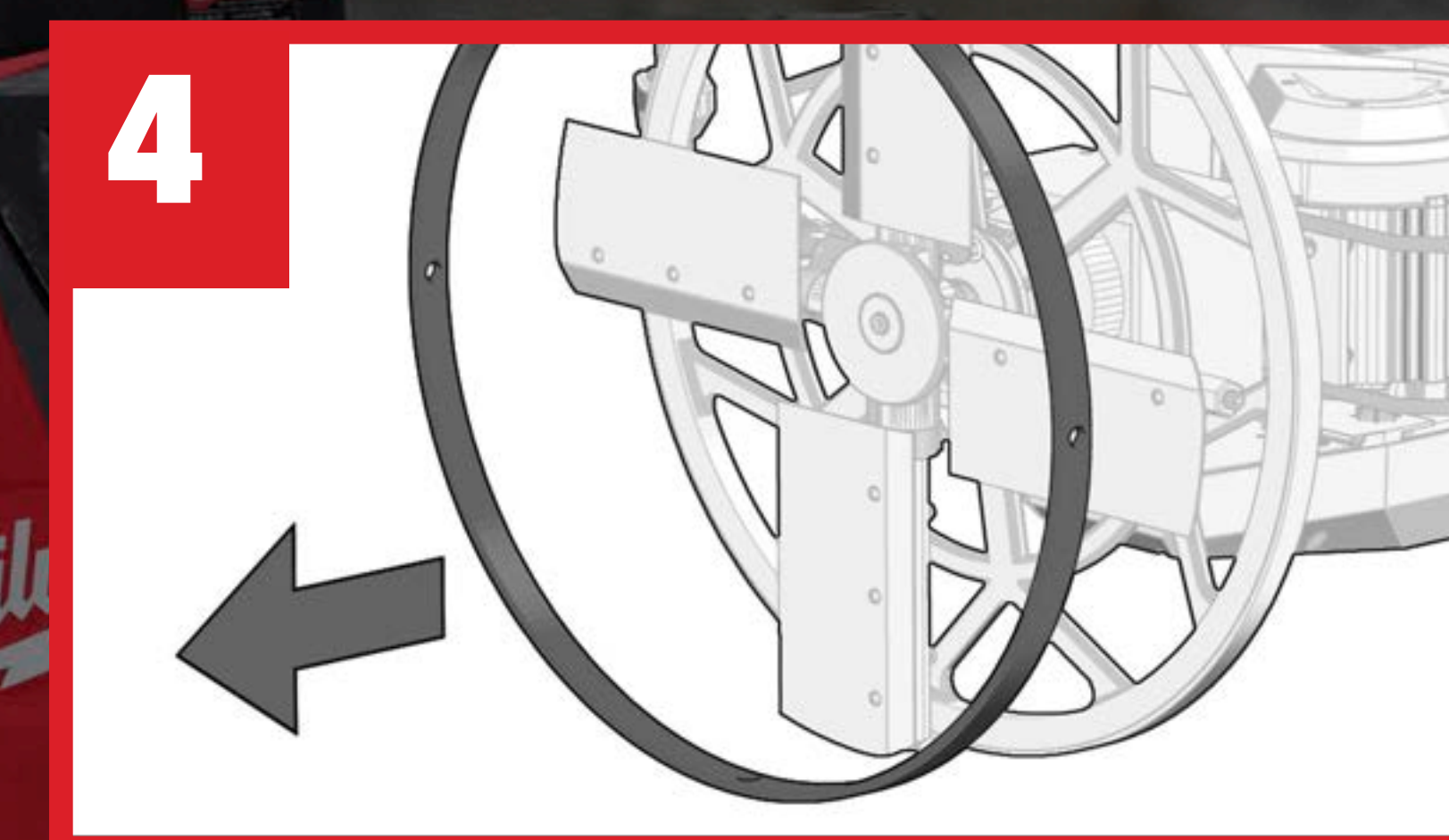
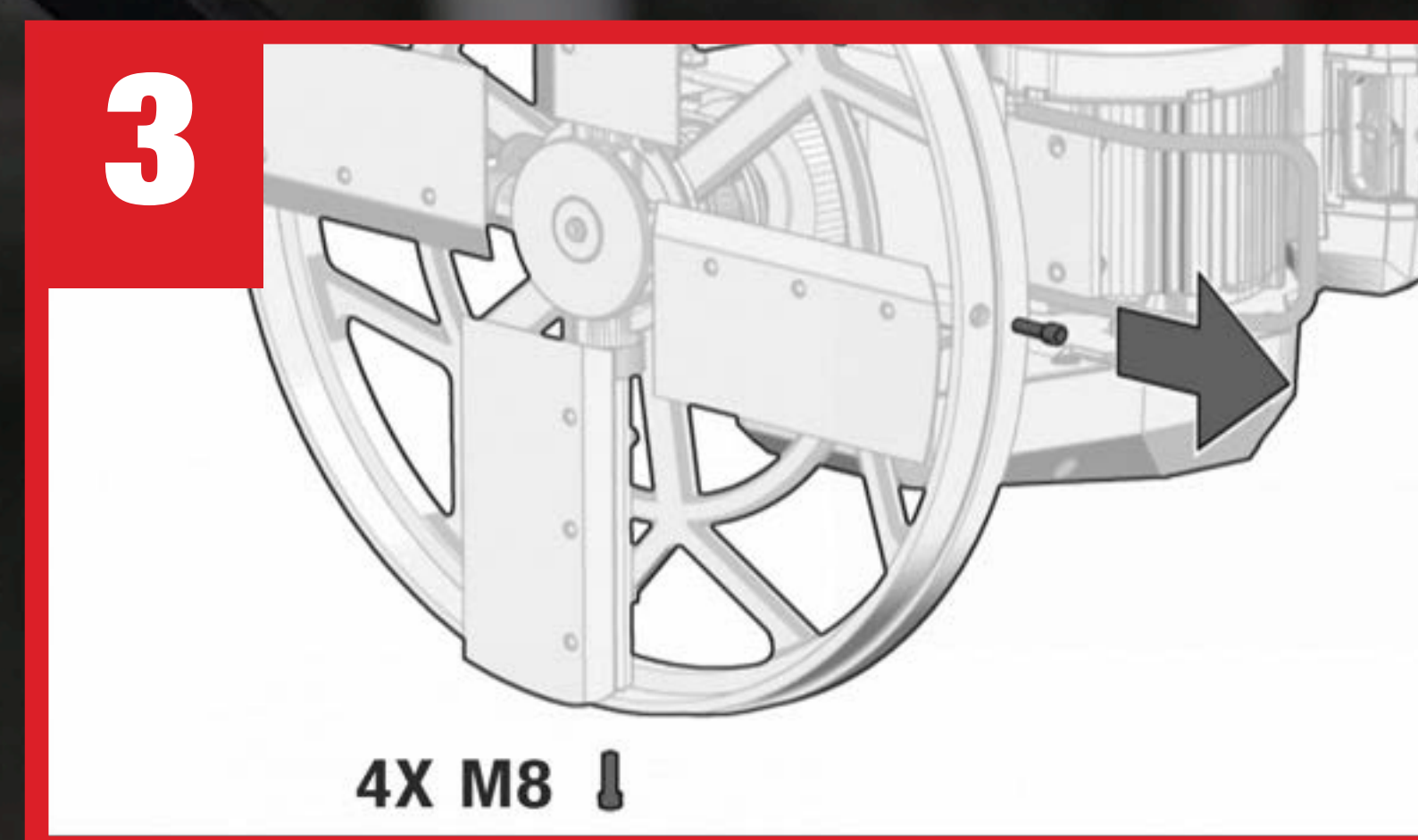
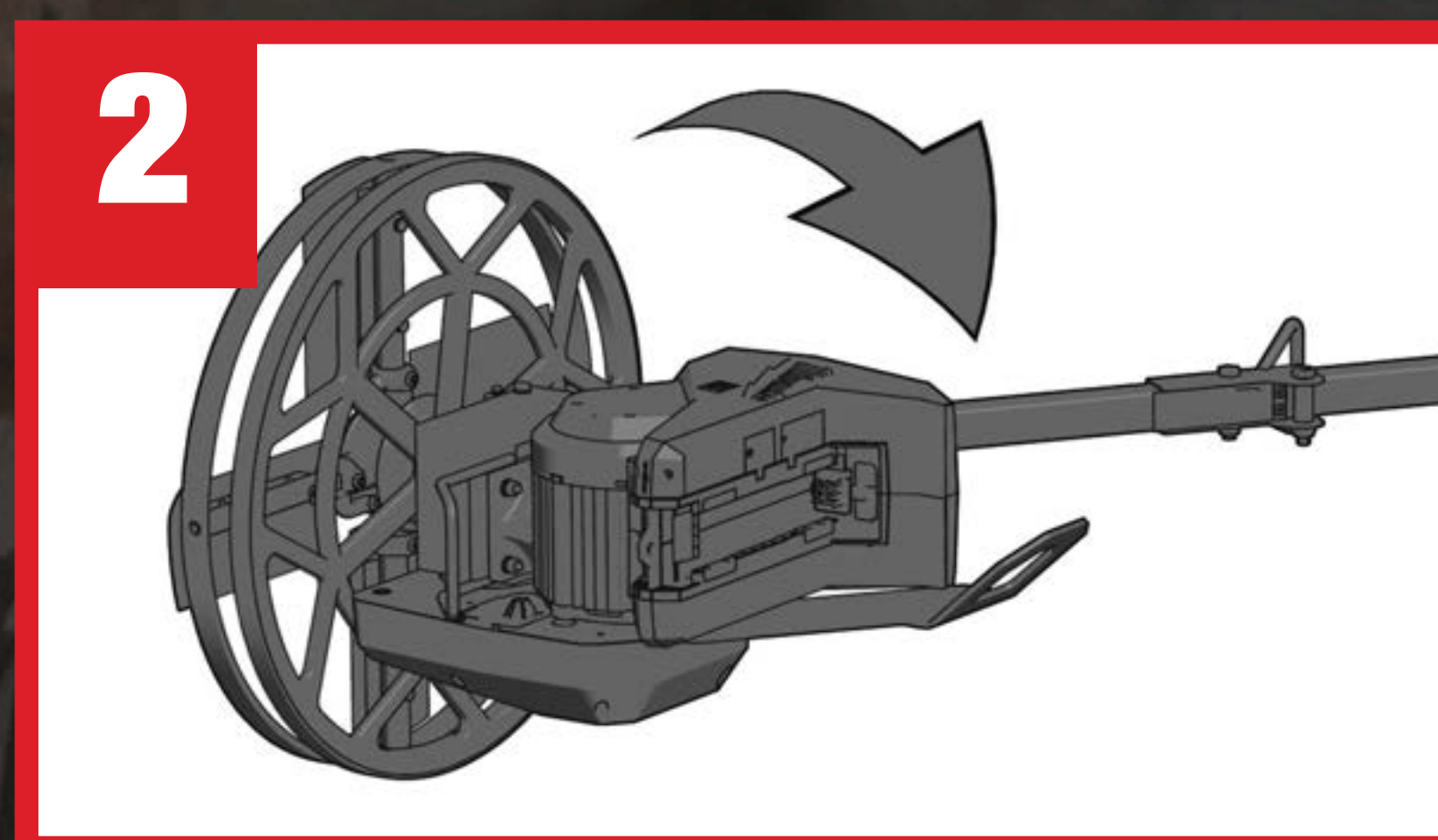





MXF WBT60

Make sure to be safe and respect the instructions written within the manual and the local regulations.

## LUBRICATION POINTS PT.2

**9. Pull and turn each arm 5 to 6 times**

**10. Push the arms all the way back in**

**11. Re-insert the worm bolts**

**12. Put it 45° back after tightening**

**13. Put back the nuts and tighten with 21-24 Nm**

**14. The arms are correctly installed when you can turn them both ways**

**15. Put EP2 lithium complex grease onto the shaft of the machine**

**16. To push in the grease, move the ring in and out**

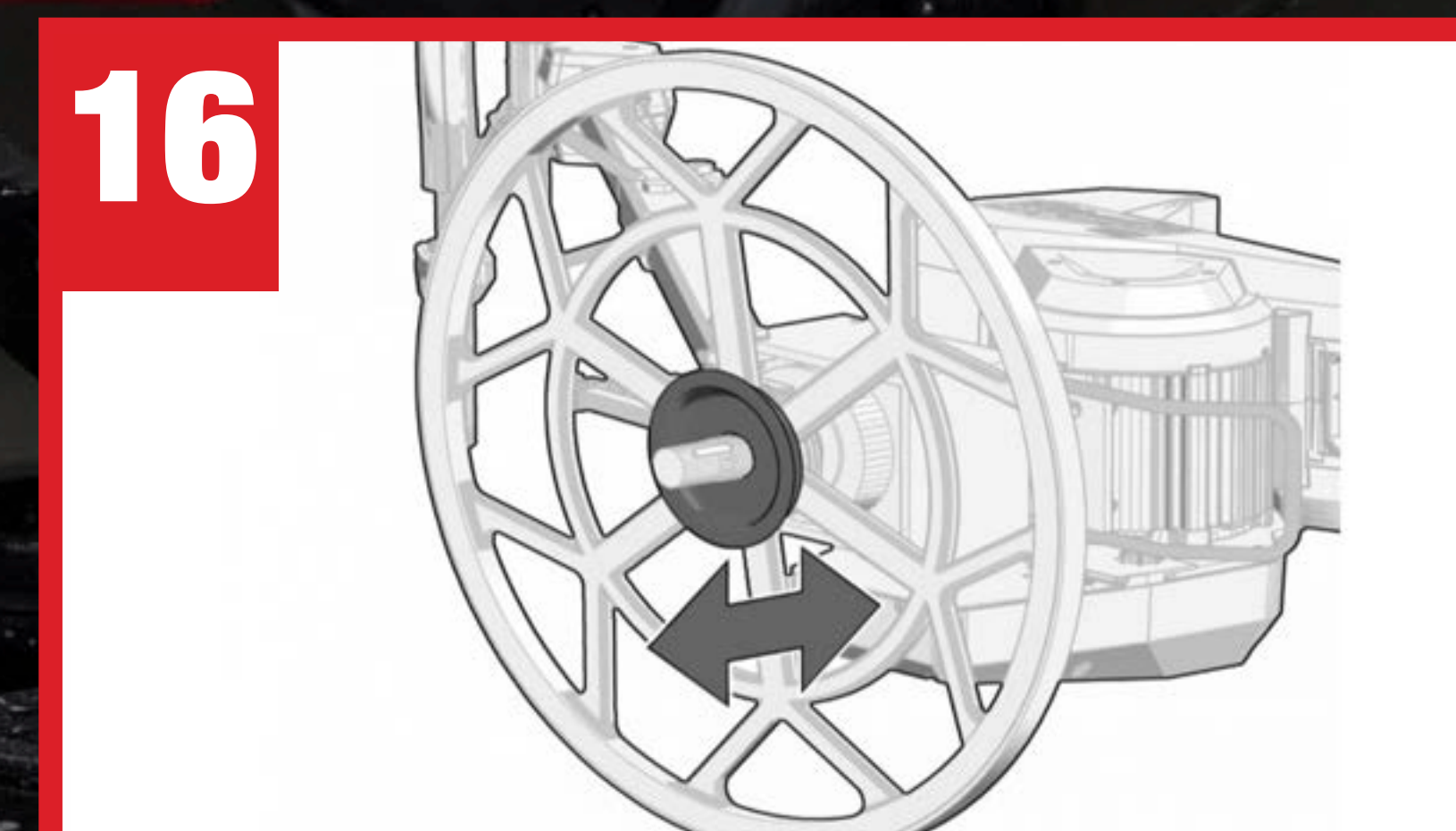
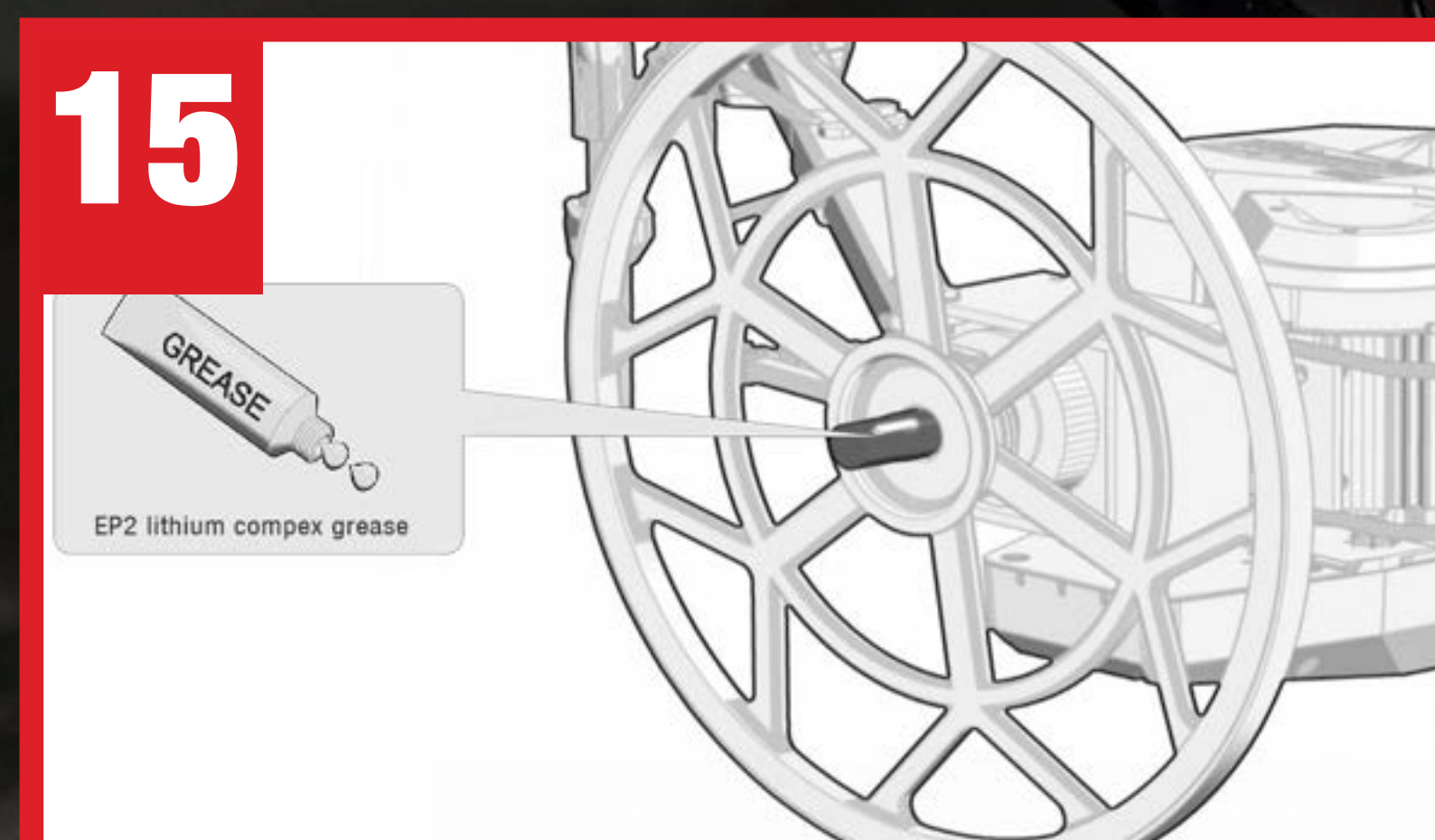
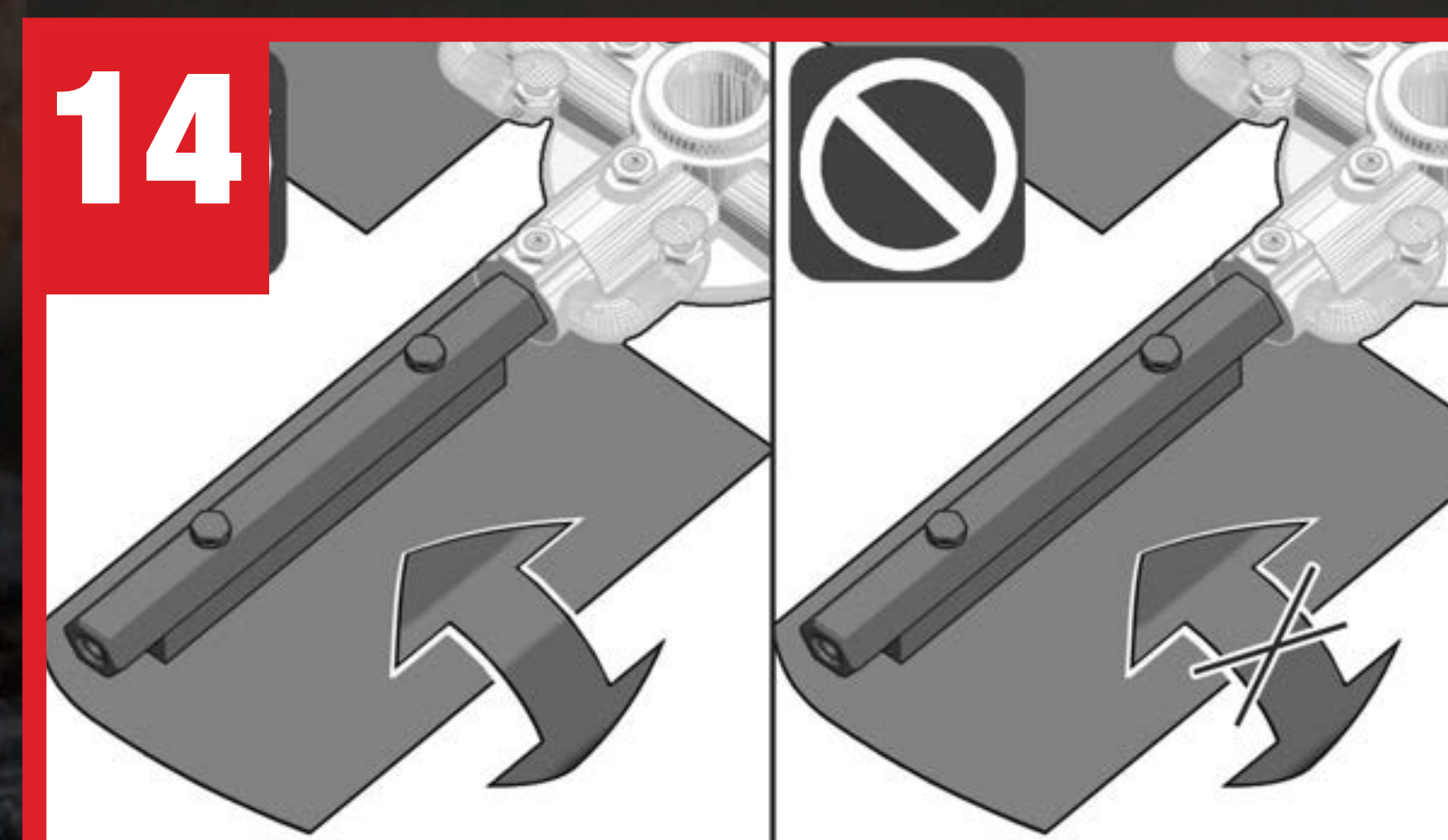
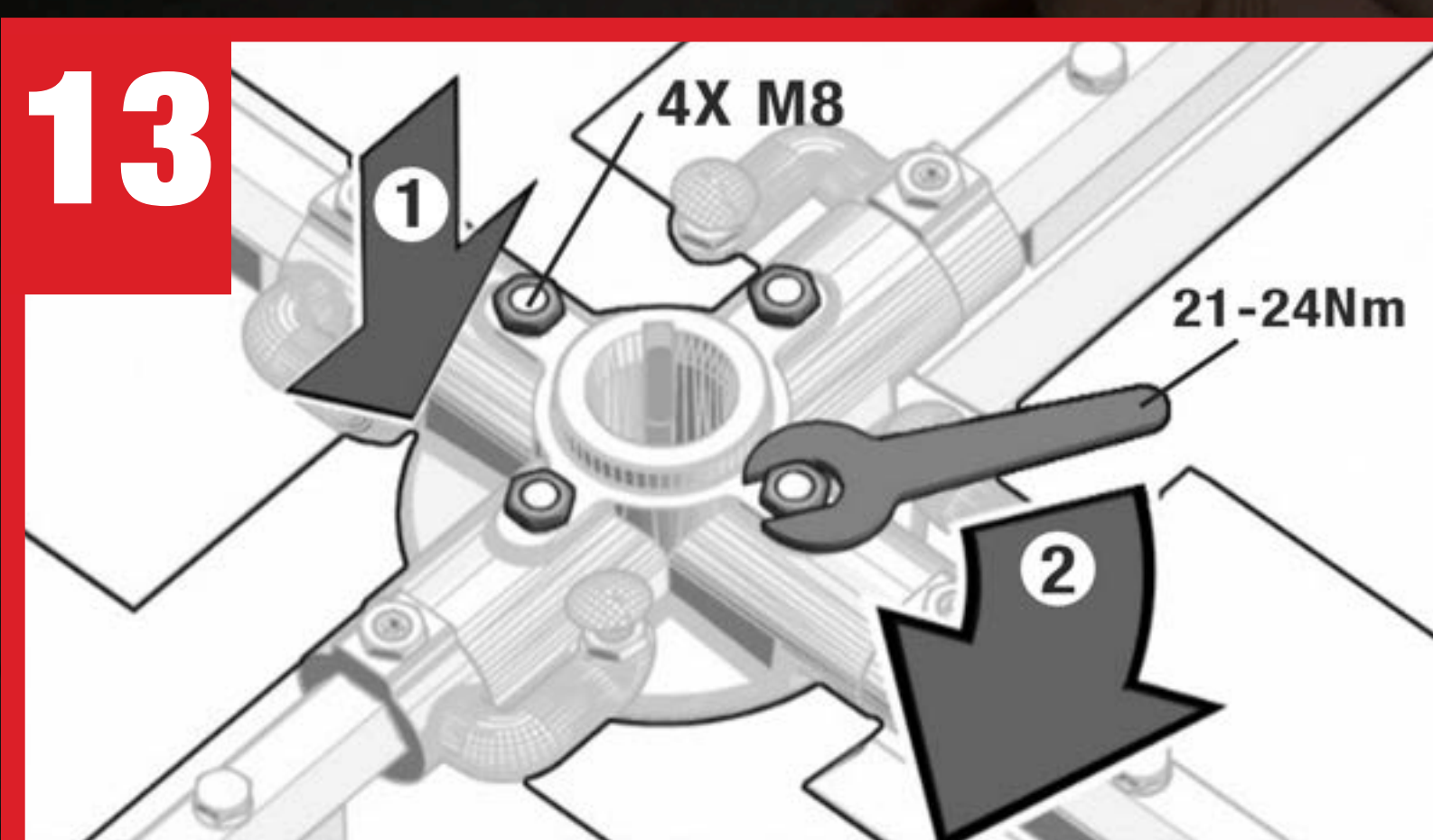
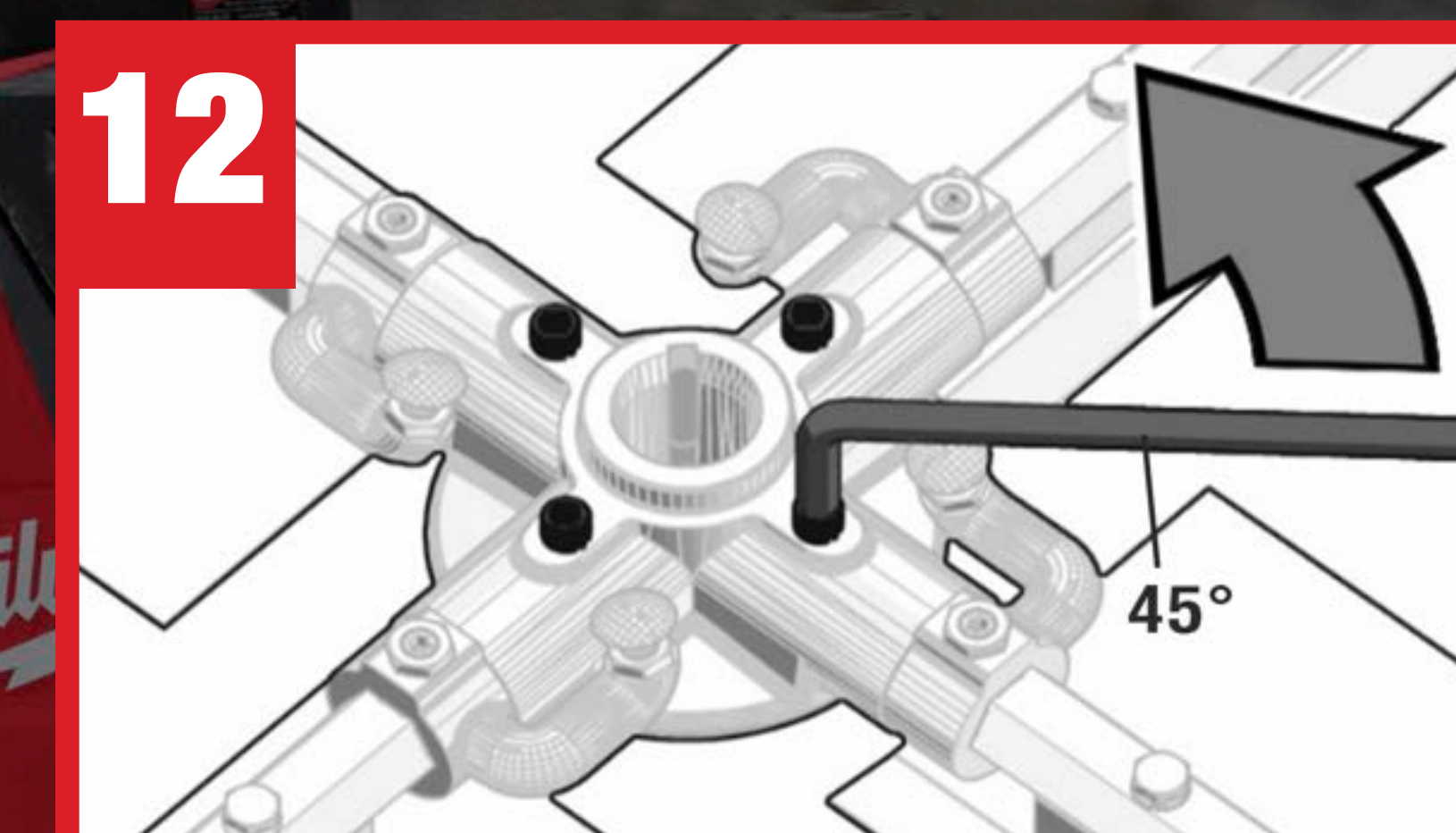
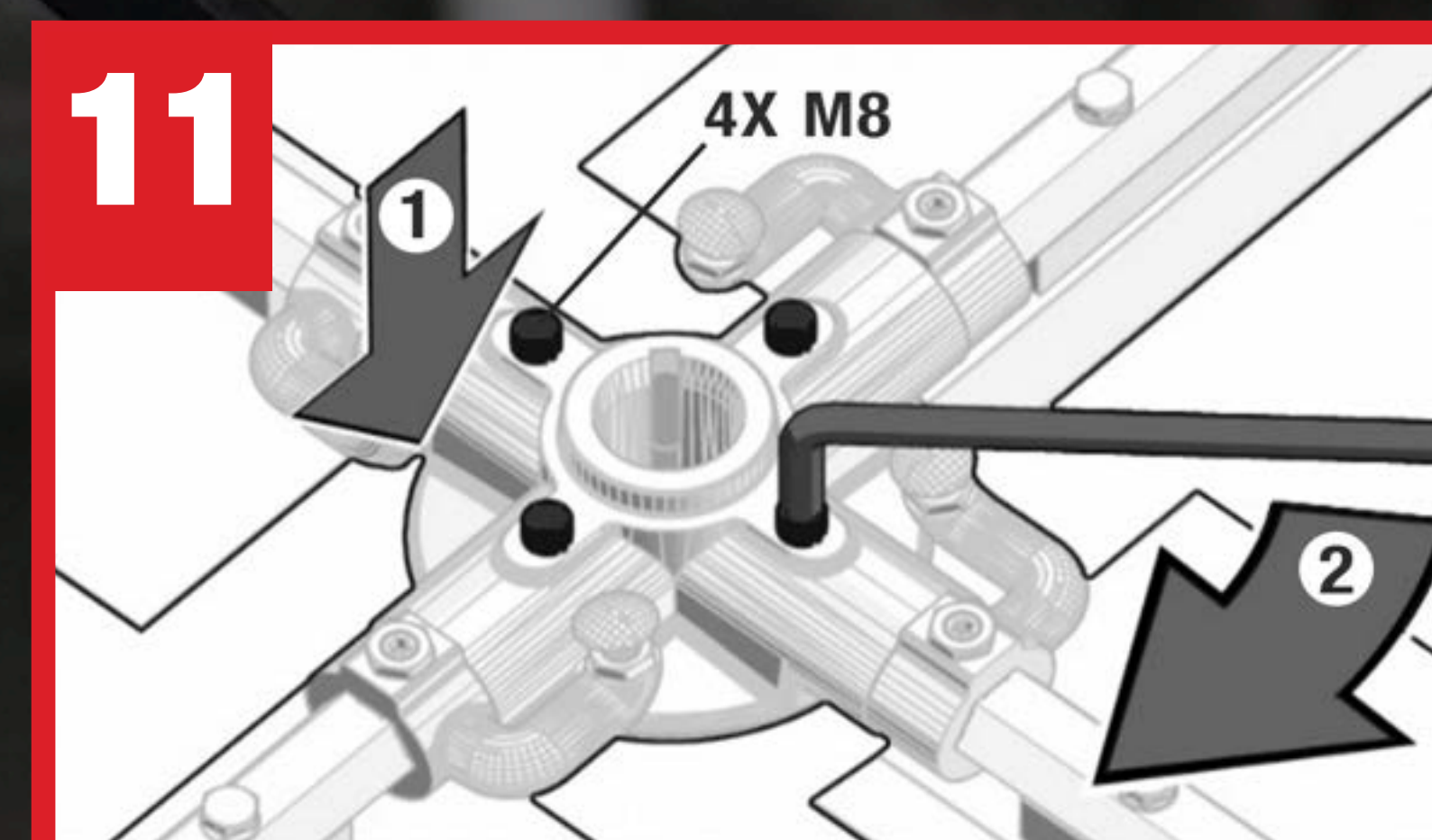
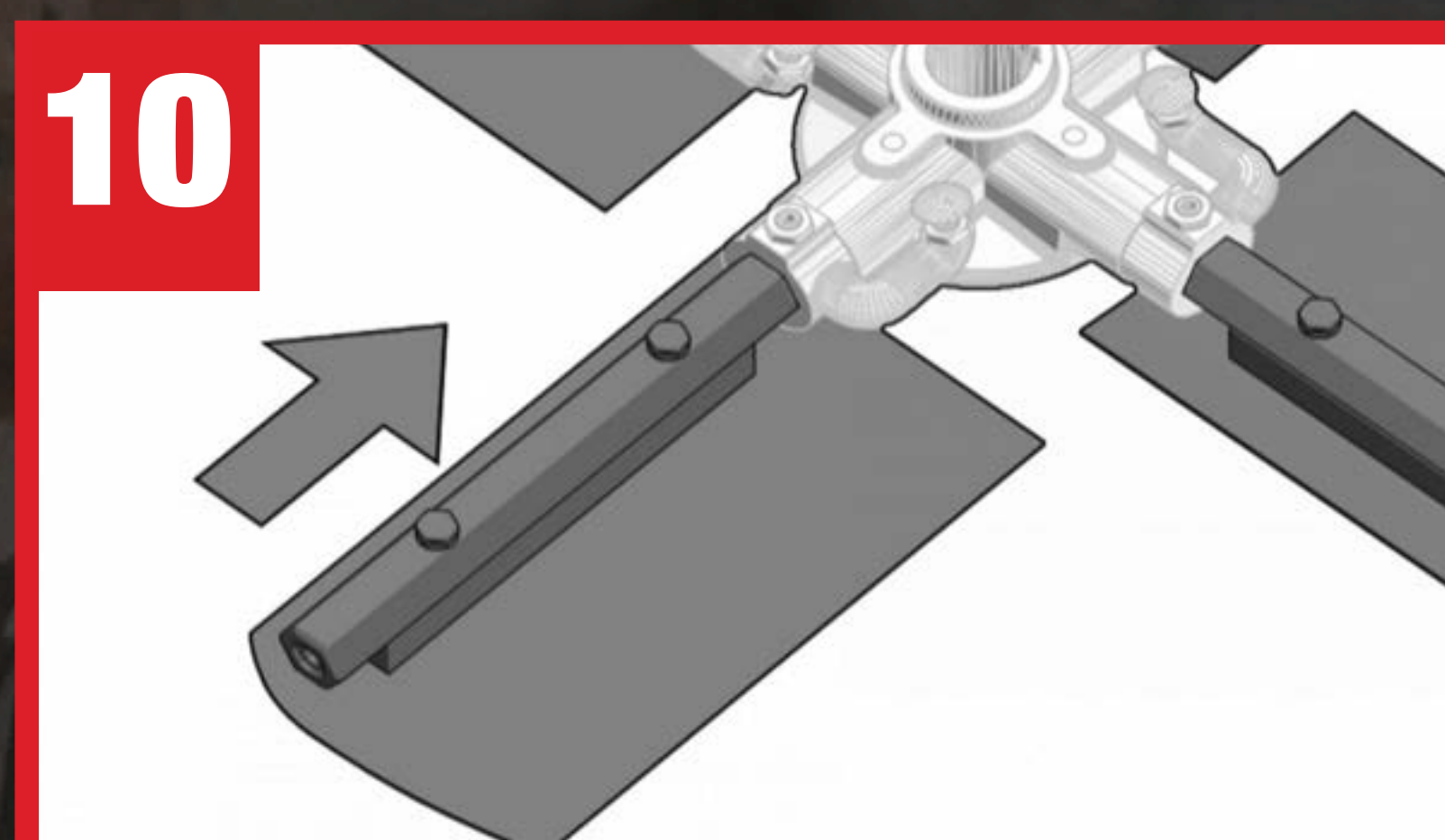
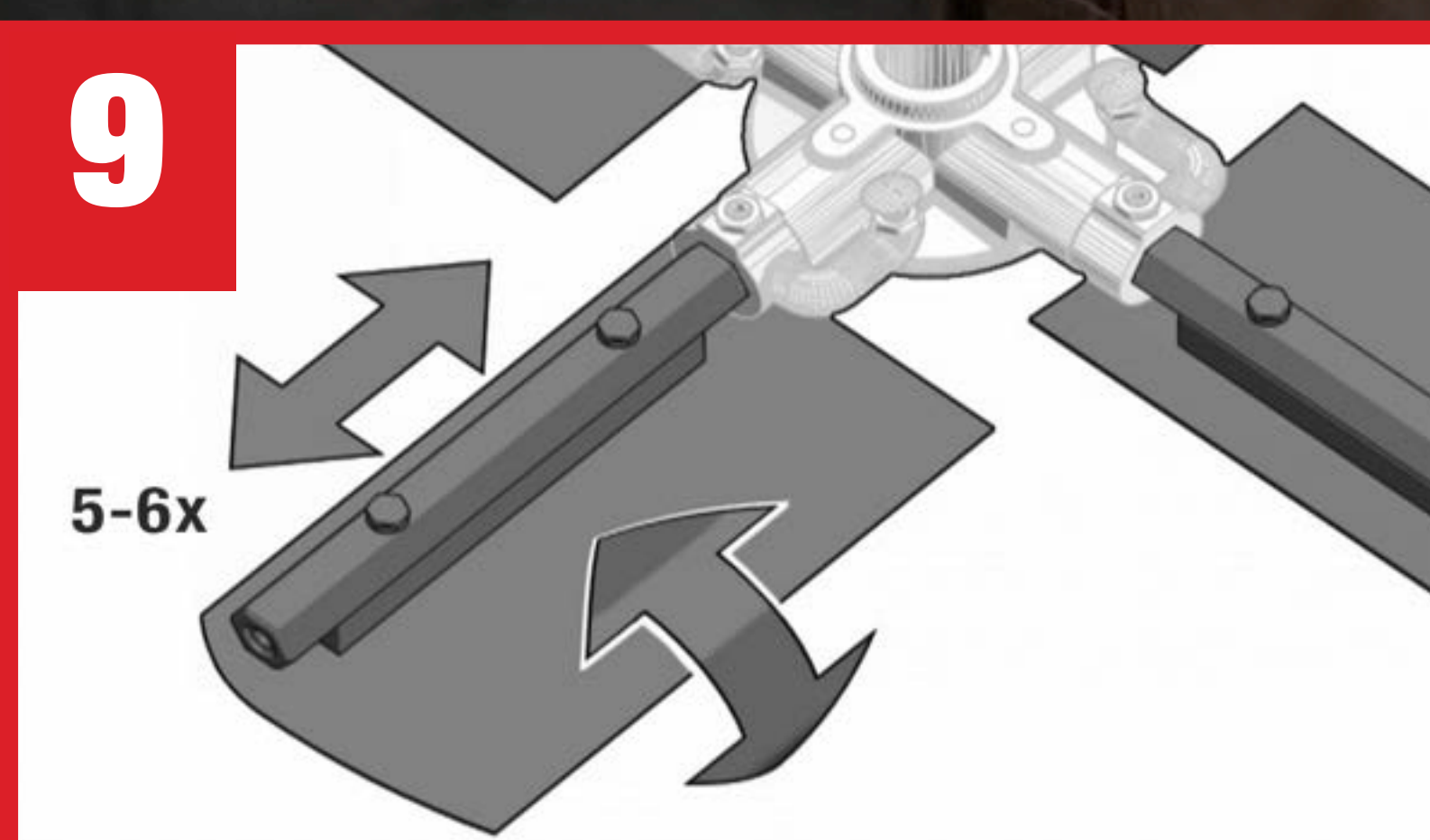





MXF WBT60

Make sure to be safe and respect the instructions written within the manual and the local regulations.

## LUBRICATION POINTS PT.3

- 17. Remove the cage half way off**
- 18. Put EP2 lithium complex grease behind the cage**
- 19. Push the cage back in place**
- 20. Put the arms back on and tighten the M8 bolt with 21-24 Nm**

- 21. Put the outer ring back on**
- 22. Tighten the 4 M8 bolts on the outer ring with 21-24 Nm**
- 23. Flip the trowel back into the working position**
- 24. Put the trowel back on the pan**

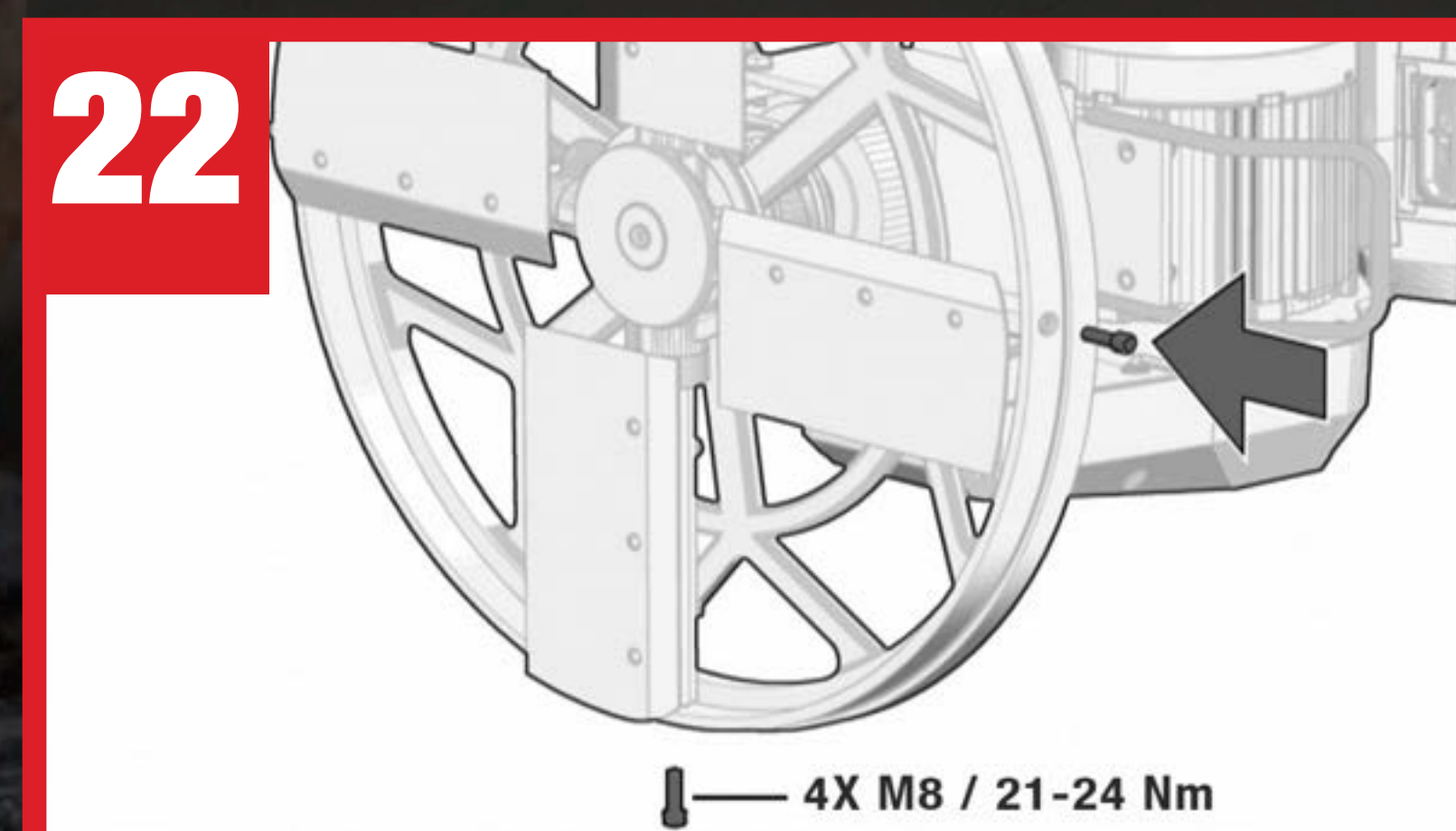
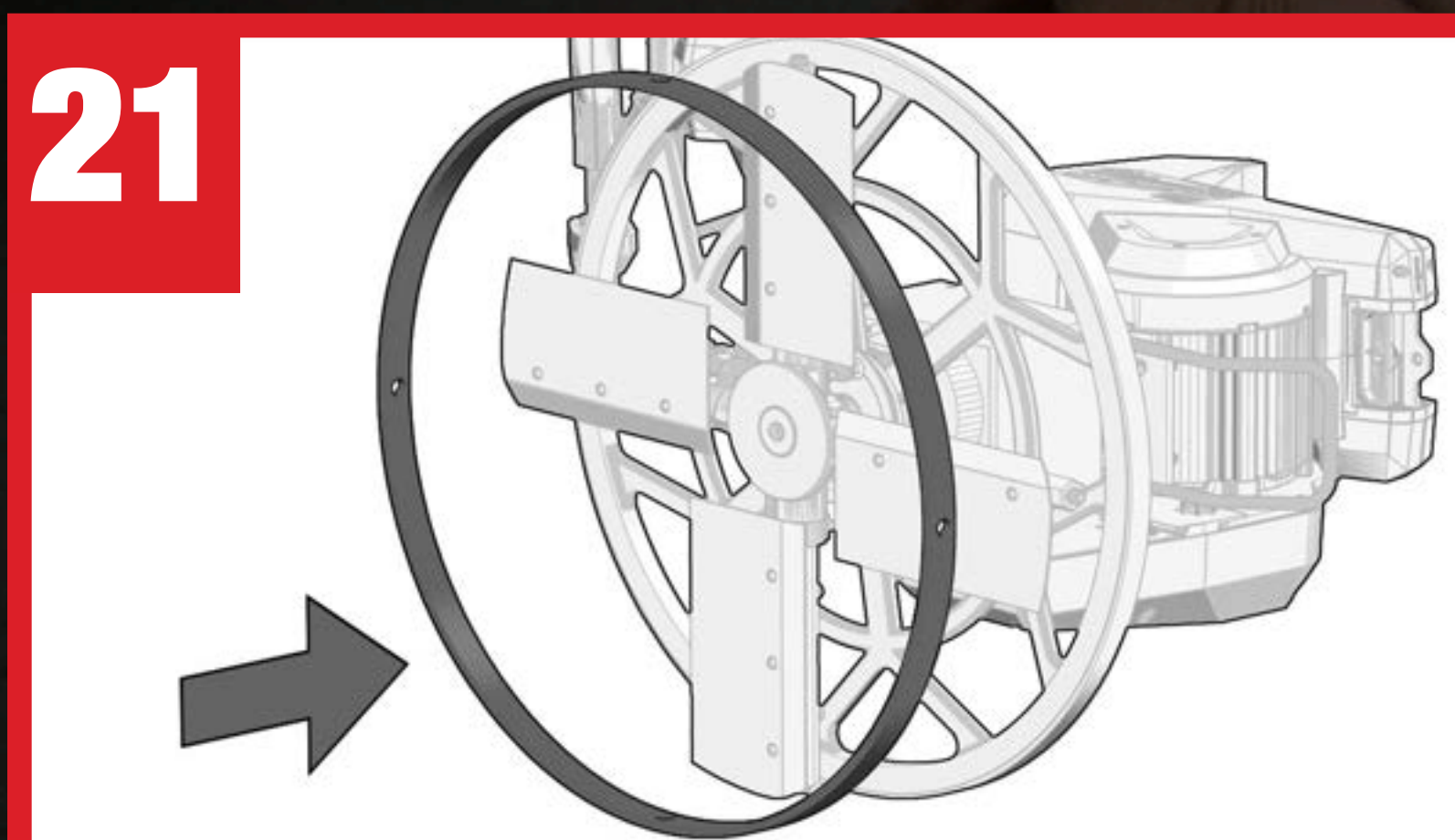
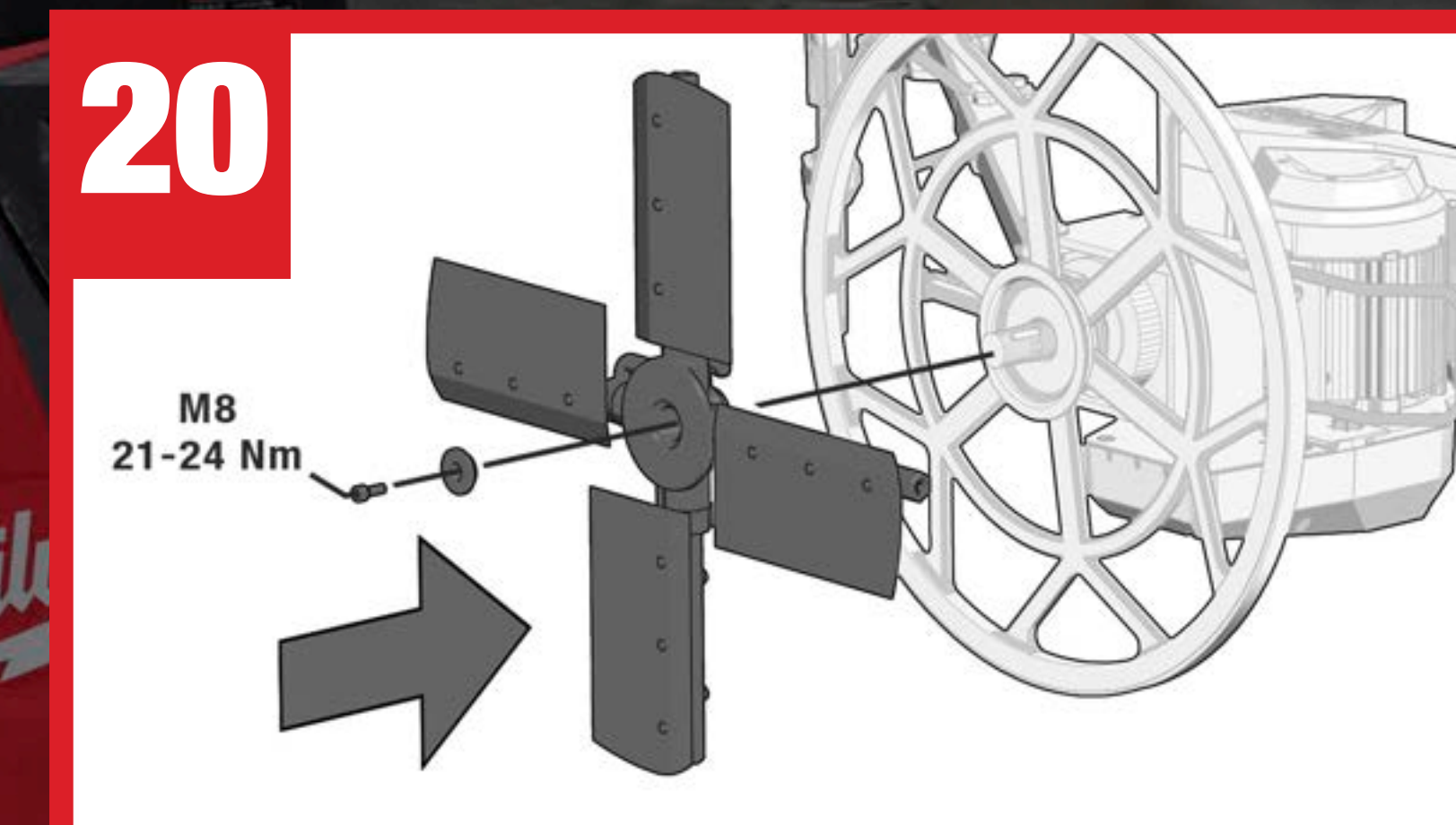
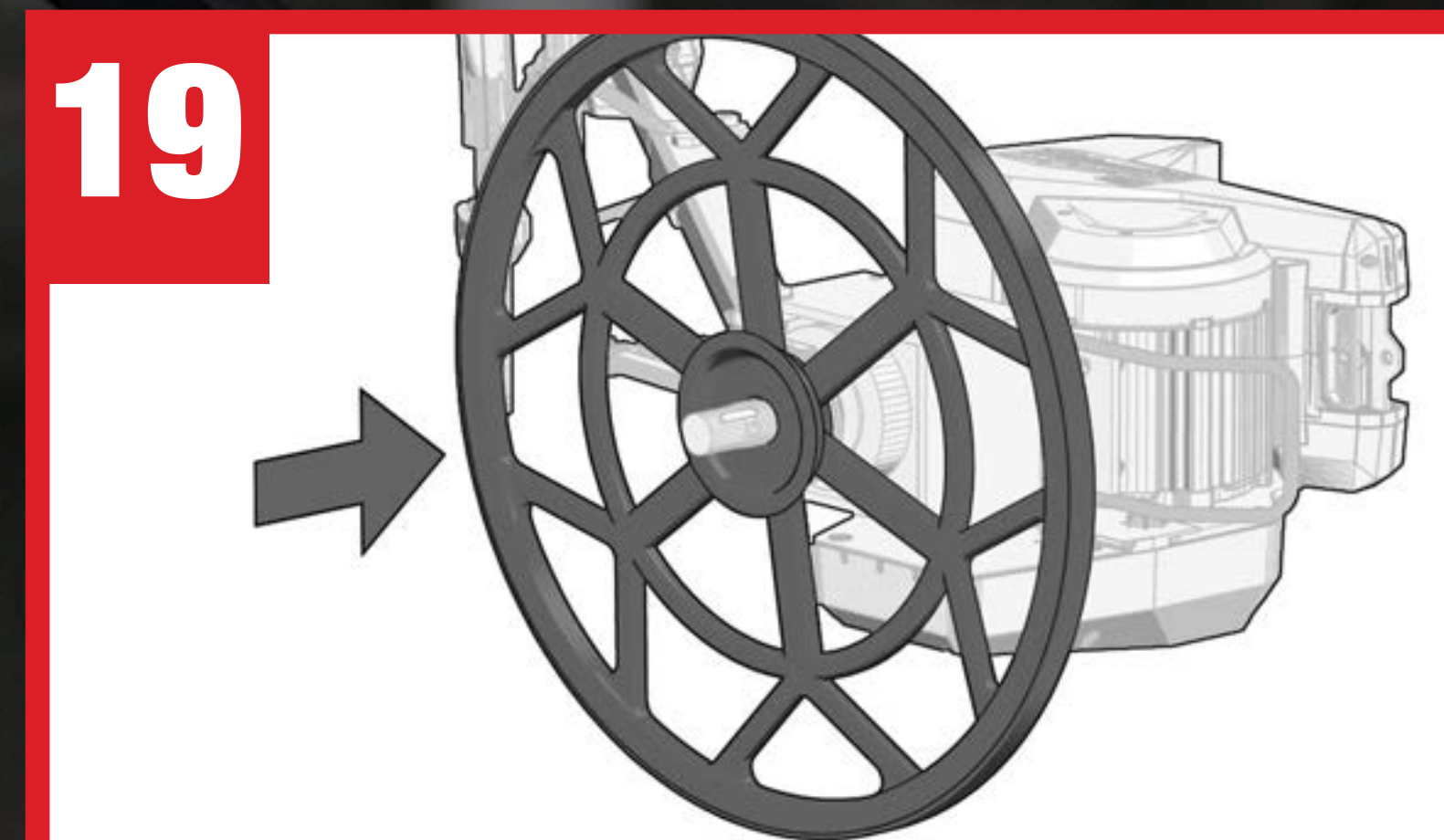
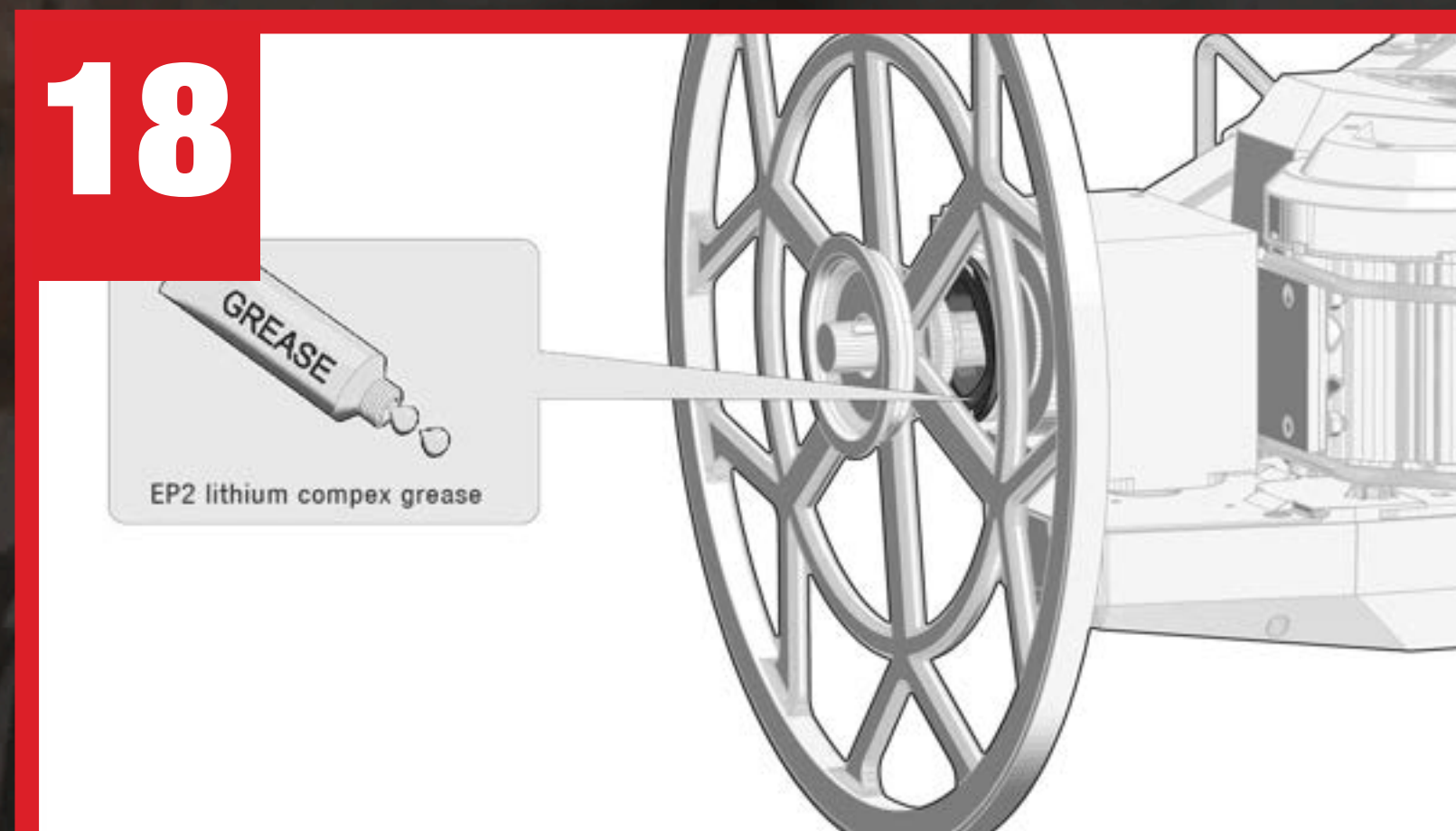
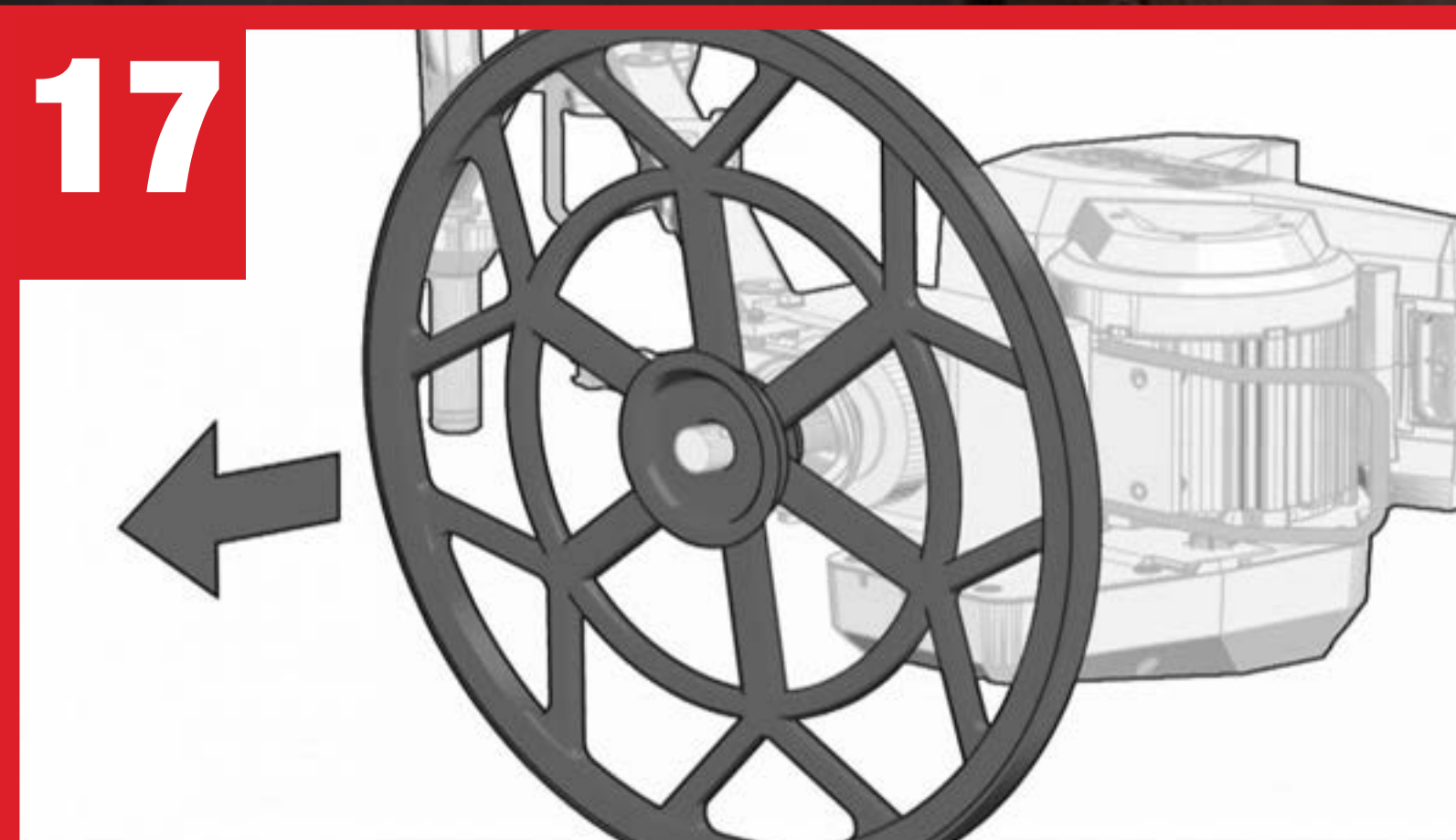





MXF WBT60

Make sure to be safe and respect the instructions written within the manual and the local regulations.

## LUBRICATION POINTS HANDLE

- 1. Open the blade angle adjustment all the way**
- 2. Insert EP2 lithium complex grease**
- 3. Close the blade angle adjustment to the desired angle**

