



Nothing but **HEAVY DUTY.**[®]



ML-LED

Original instructions

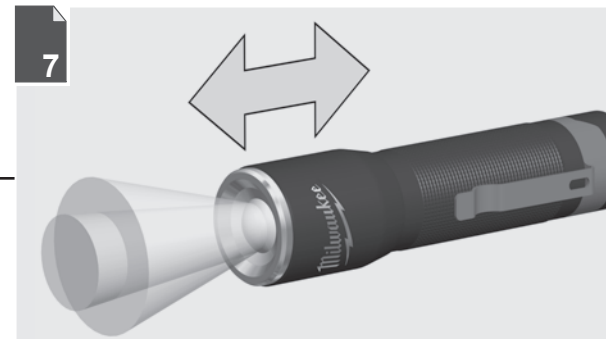
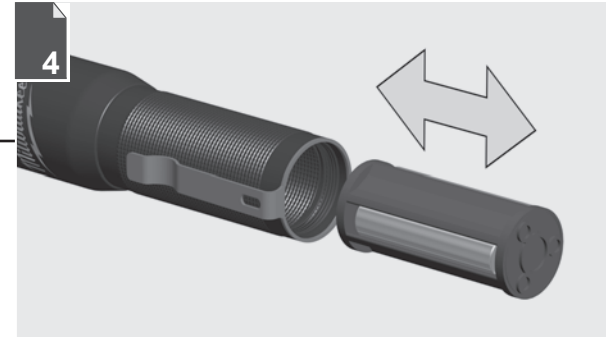
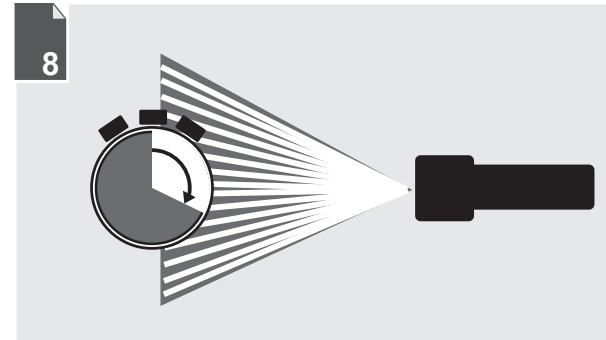
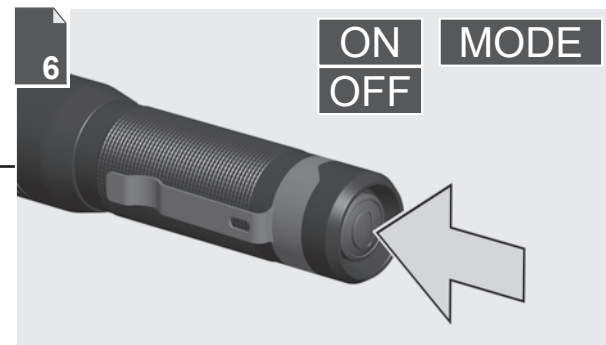

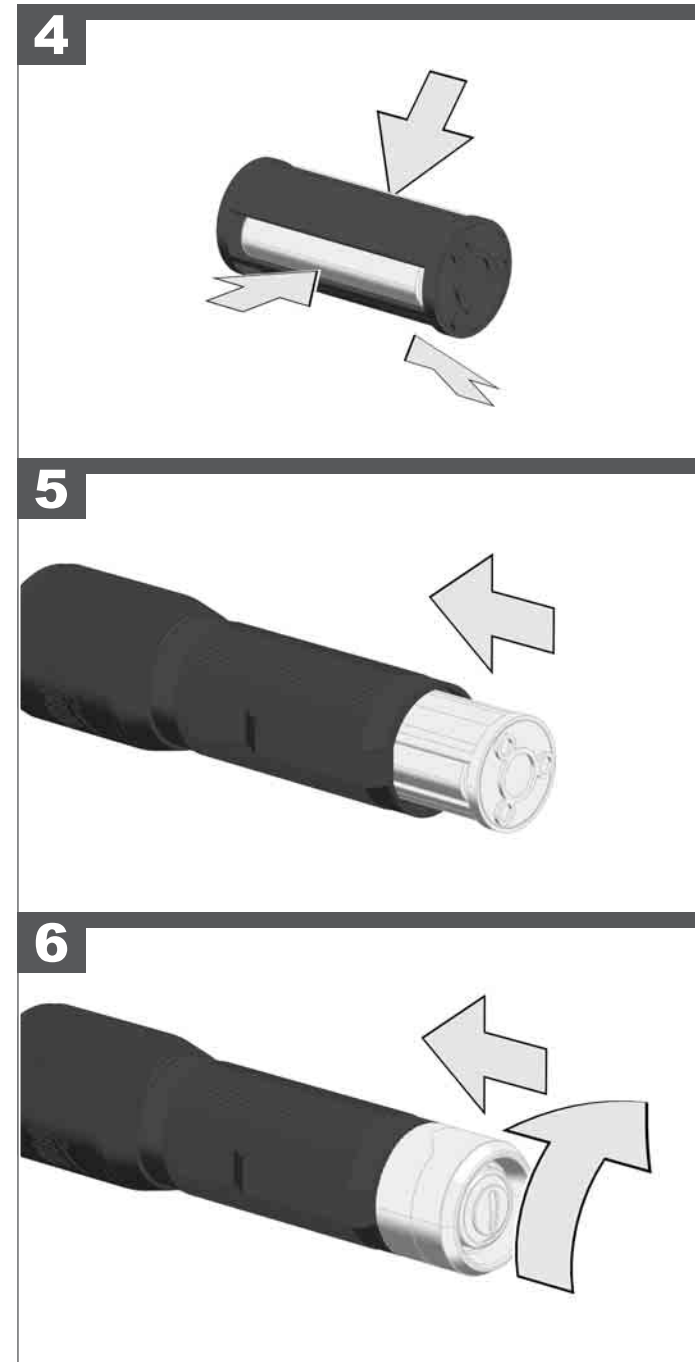
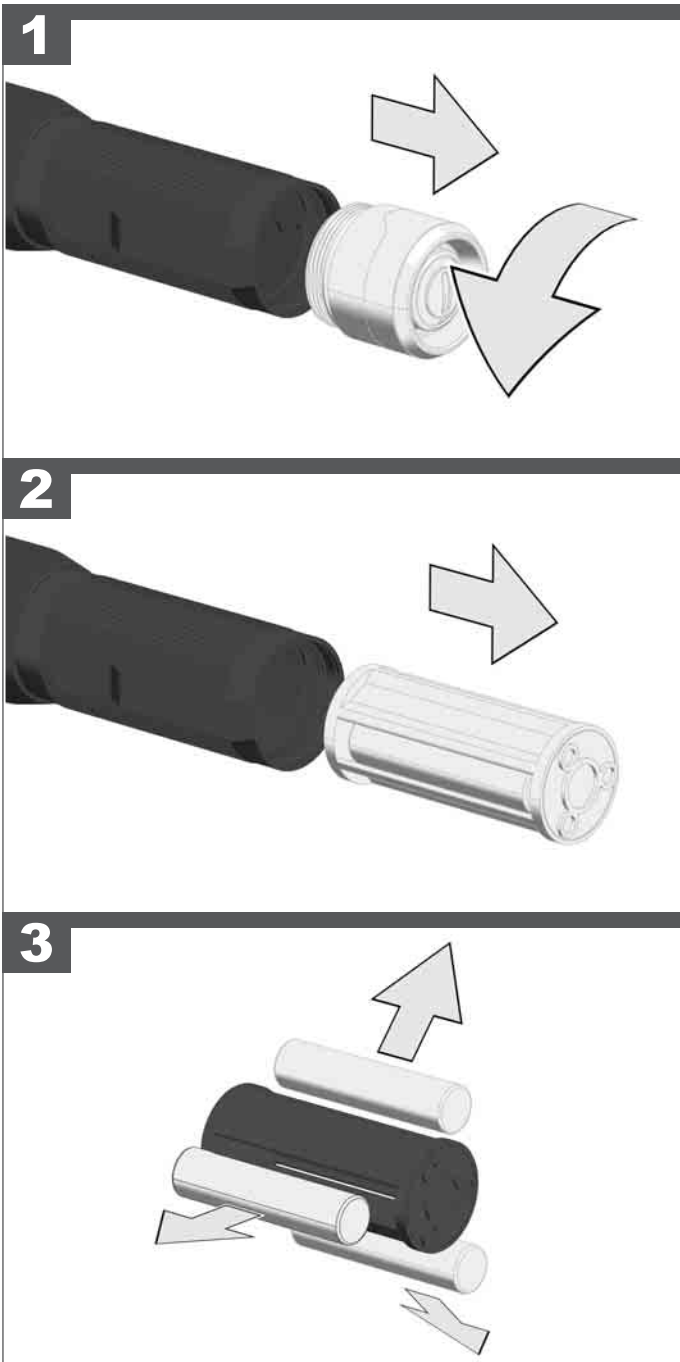
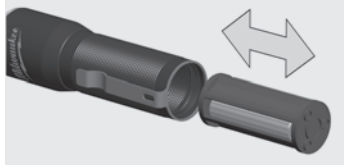

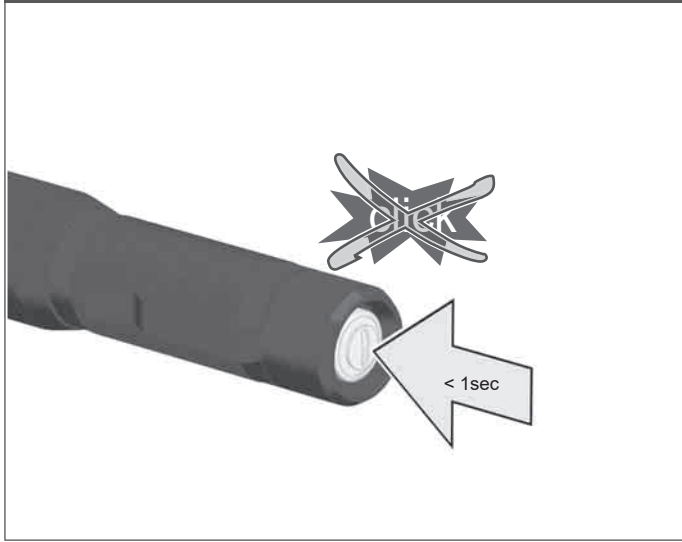
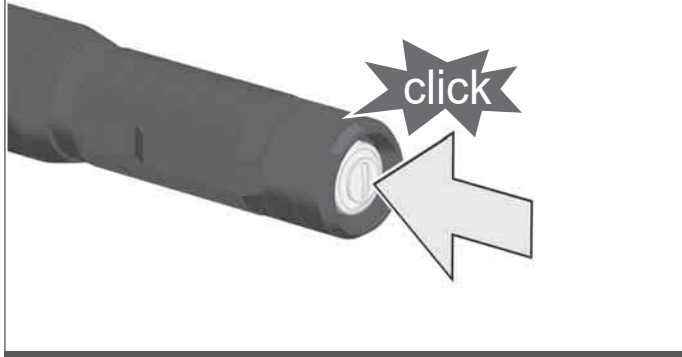
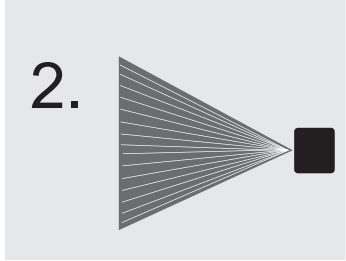
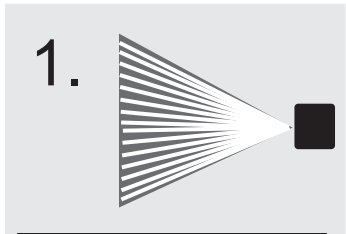
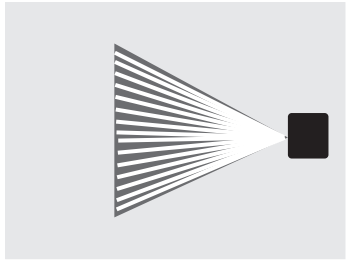
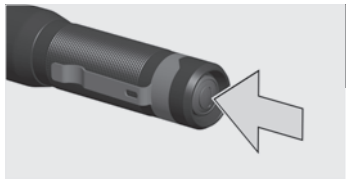

Dual function power button
 Press firmly (click) -> on/off
 Press softly -> momentary on
 Press softly under 1 sec. -> cycle through the modes

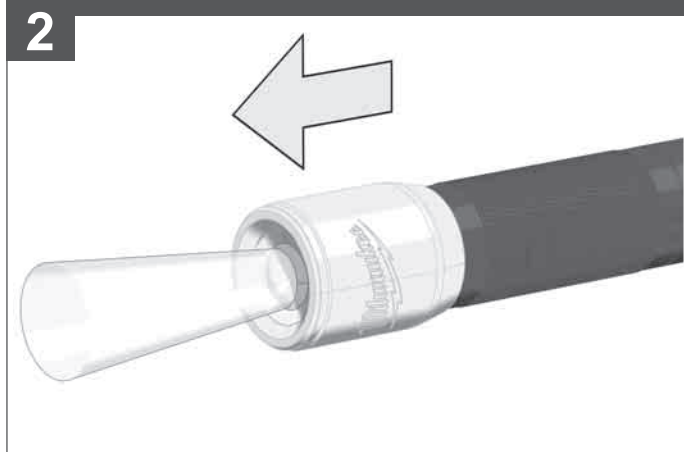
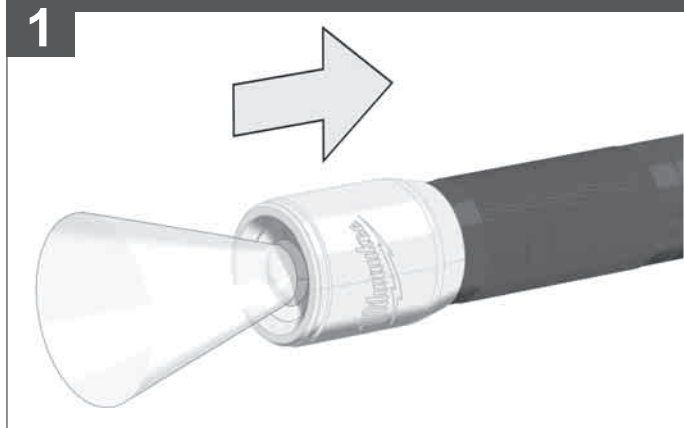
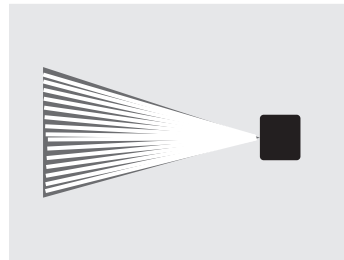
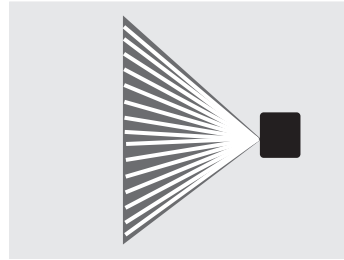
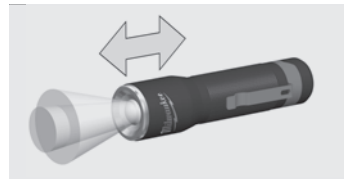

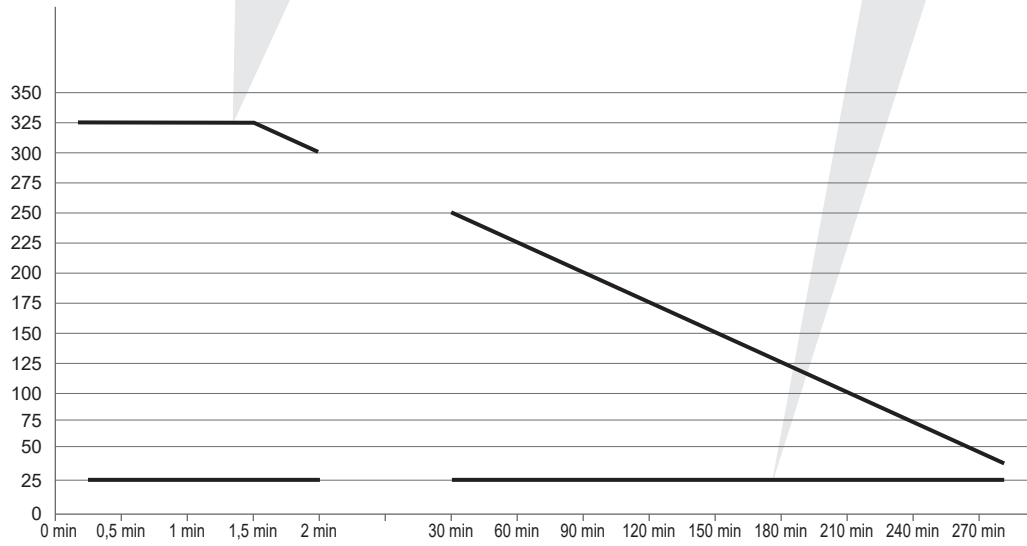
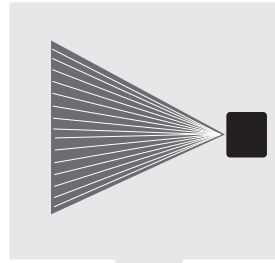
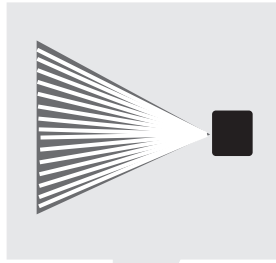

| TECHNICAL DATA | BATTERY LAMP | ML-LED |
|---|--------------|----------------|
| Rated Power input..... | | 4 W |
| Lighting time | | |
| Mode High | | 5 h |
| Mode Low | | 18 h |
| Luminous flux | | |
| Mode High | | 325 lm |
| Mode Low | | 25 lm |
| Colour rendering index (CRI)..... | | 80 |
| Colour temperature..... | | 4000 K |
| Battery voltage..... | | 4,5 V (3x1,5V) |
| Battery type | | LR03 / AAA |
| Weight according EPTA-Procedure 01/2014 | | 0,13 kg |
| Protection class | | IP 67 |

⚠ WARNING Read all safety warnings, instructions, illustrations and specifications provided with this power tool. Failure to follow all instructions listed below may result in electric shock, fire and/or serious injury. Save all warnings and instructions for future reference.

⚠ SAFETY INSTRUCTIONS BATTERY LAMP

Warning: Do not direct the light beam at persons or animals and do not stare into the light beam yourself (not even from a distance). Staring into the light beam may result in serious injury or vision loss.
 Don't use this tool in wet areas .
 The light source of this luminaire is not replaceable; when the light source reaches its end of life the whole luminaire shall be replaced.

⚠ SAFETY INSTRUCTIONS BATTERY

This tool is designed to be powered by 3 LR03 / AAA batteries properly inserted into the instrument. Do not attempt to use with any other voltage or power supply. Do not leave batteries within the reach of children. Do not mix new and used batteries. Do not mix brands (or types within brands) of batteries. Do not mix rechargeable and non-rechargeable batteries. Install batteries according to polarity (+ / -) diagrams. Properly dispose of used batteries immediately. Battery acid may leak from damaged batteries under extreme load or extreme temperatures. In case of contact with battery acid wash it off immediately with soap and water. In case of eye contact rinse thoroughly for at least 10 minutes and immediately seek medical attention.









SPECIFIED CONDITIONS OF USE

The Battery Lamp is intended to be used light independent use away from mains supply. Do not use this product in any other way as stated for normal use.

MAINTENANCE

The light source of this luminaire is not replaceable; when the light source reaches its end of life the whole luminaire shall be replaced.
 Use only Milwaukee accessories and spare parts. Should components need to be replaced which have not been described, please contact one of our Milwaukee service agents (see our list of guarantee/service addresses). If needed, an exploded view of the tool can be ordered. Please state the machine type printed as well as the six-digit No. on the label and order the drawing at your local service agents or directly at: Techtronic Industries GmbH, Max-Eyth-Straße 10, 71364 Winnenden, Germany.

SYMBOLS

| | |
|--|---|
|  | CAUTION! WARNING! DANGER! |
|  | Please read the instructions carefully before starting the machine. |
|  | Do not stare at the operating light source. |
|  | Class III electrical protection. |
|  | Do not dispose electric tools, batteries/ rechargeable batteries together with household waste material. Electric tools and batteries that have reached the end of their life must be collected separately and returned to an environmentally compatible recycling facility. Check with your local authority or retailer for recycling advice and collection point. |
|  | European Conformity Mark |
|  | Ukraine Conformity Mark |
|  | EurAsian Conformity Mark |

Copyright 2020
Techtronic Industries GmbH
Max-Eyth-Str. 10
71364 Winnenden
Germany
+49 (0) 7195-12-0
www.milwaukeeetool.eu

Techtronic Industries (UK) Ltd
Fieldhouse Lane
Marlow Bucks SL7 1HZ
UK

 **EAC UK
CA**
(10.20)
4100 4701 07