

# ON/OFF

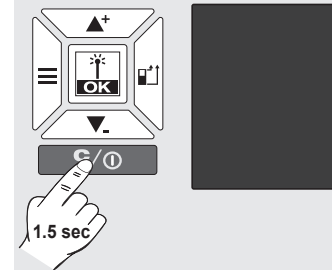

# NAVIGATION

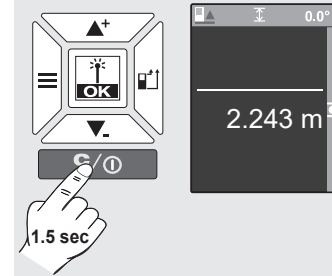
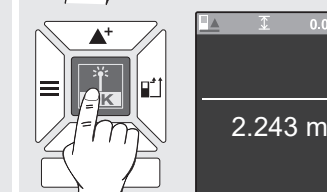
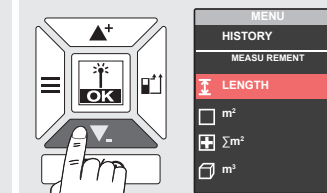
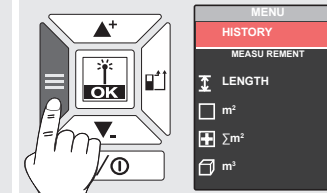

# HISTORY

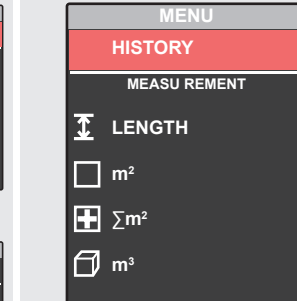

Store measurements  
Messergebnisspeicher  
Sauvegarder la valeur mesurée  
Salva il valore misurato  
Guardar el valor medido  
Memorizar o valor de medição  
Meetwaarde opslaan  
Gem måleværdi  
Spara mätvärde  
Tallenna mittausarvo  
Απομνημόνευση τιμής μετρήσεως  
Ölçüm deęerini kaydet  
Uložít naměřenou hodnotu  
Uložít nameranú hodnotu

Zapisz wynik pomiaru  
Mért érték mentése  
Shrani merilno vrednost  
Saglabát mērījuma vērtību  
Íšsaugoti matavimo vertę  
Mõõtmisväärtuse salvestamine  
Сохранить результат измерения  
Запам'ятованє на отчетената стойност  
Salvare valoare măsurată  
Зачуванье на измерената вредност  
Зберетти результат вимірювання  
حفظ القيمة التي تم قوليها

# MEASUREMENT

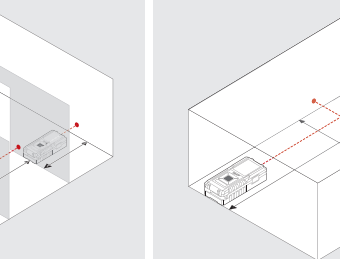
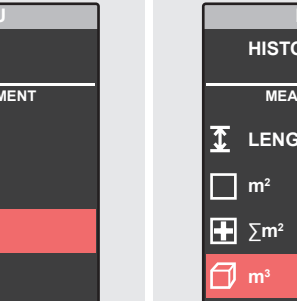
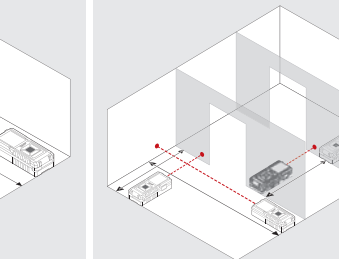
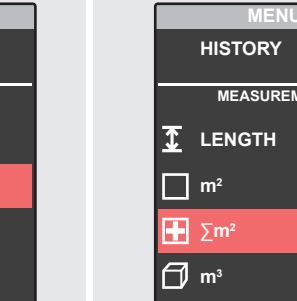
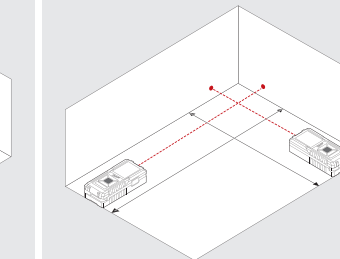
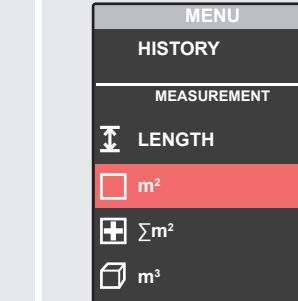
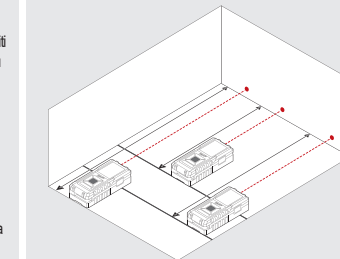
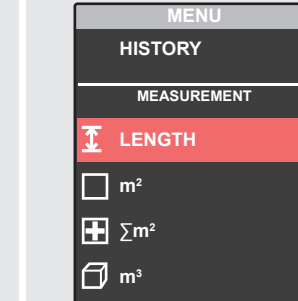

# MEASUREMENT

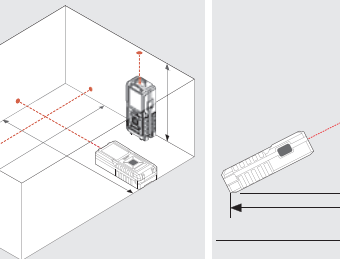
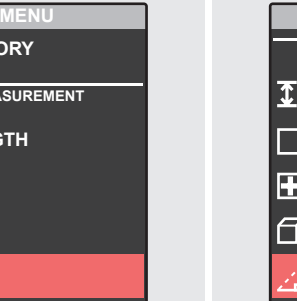

# LDM 100

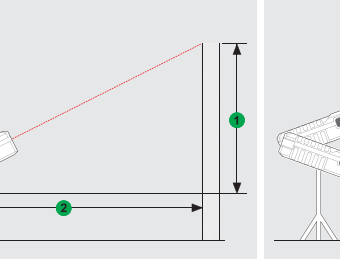
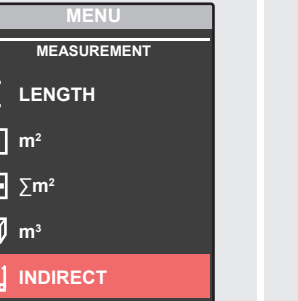

# LDM 100

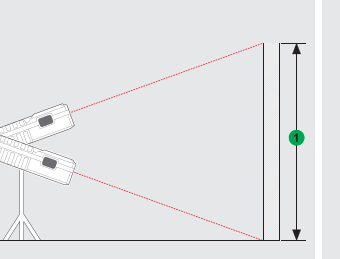
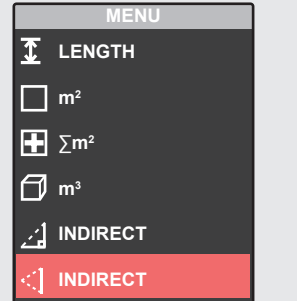

# SETTINGS

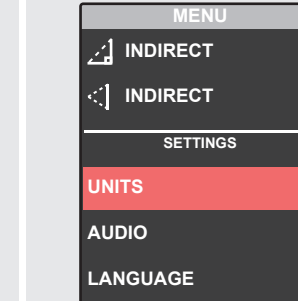

ft <-> m

# SETTINGS

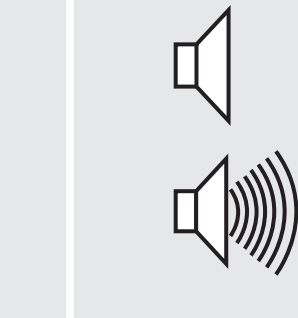
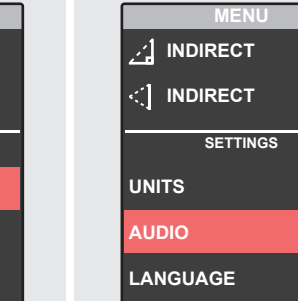

# SETTINGS

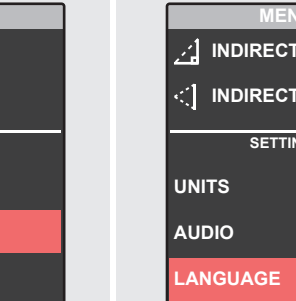

ENGLISH  
DEUTSCH  
FRANÇAIS  
ITALIANO  
ESPAÑOL  
PORTUGUÊS  
NETERLANDS  
DANSK  
NORSK  
SVENSKA  
SUOMI  
ΕΛΛΗΝΙΚΑ  
TÜRKÇE  
CESKY

SLOVENSKY  
POLSKI  
MAGYAR  
SLOVENSKO  
HRVATSKI  
LATVISKI  
LIETUVIŠKAI  
EESTI  
RUSSIAN  
БЪЛГАРСКИ  
ROMÂNIA  
МАКЕДОНСКИ  
УКРАЇНСЬКА  
عربي

### STATUS BAR

▶ Reference Point of Measurement, Type of Measurement, Angle (LDM 100 only), Level (LDM 100 only)

### DISPLAY

▶ Menu  
▶ Measurements  
▶ Settings

### UP / ADD

▶ navigate up through menus  
▶ add value

### MEASURE / OK

▶ turn the laser on  
▶ store measurement  
▶ select OK in the menu

### MENU

▶ History  
▶ Measurement  
▶ Settings

### DOWN / SUBTRACT

▶ navigate down through menus  
▶ subtract value

### CLEAR / POWER

▶ on / off (press and hold until unit beeps)  
▶ clear measurement

### POINT OF MEASURE

▶ Bottom (standard automatic)  
▶ Front  
▶ Corner pin (activates automatically by extending the lever)

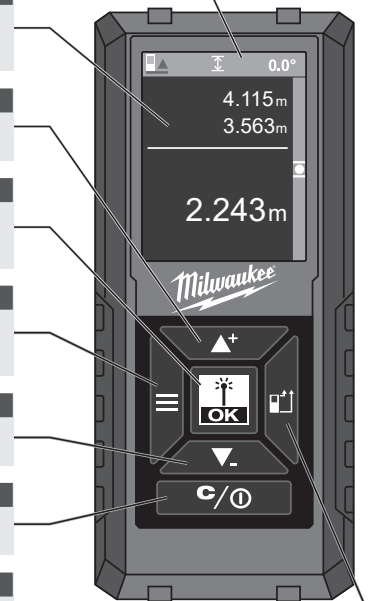

### MEASURE

▶ turn the laser on  
▶ store measurement

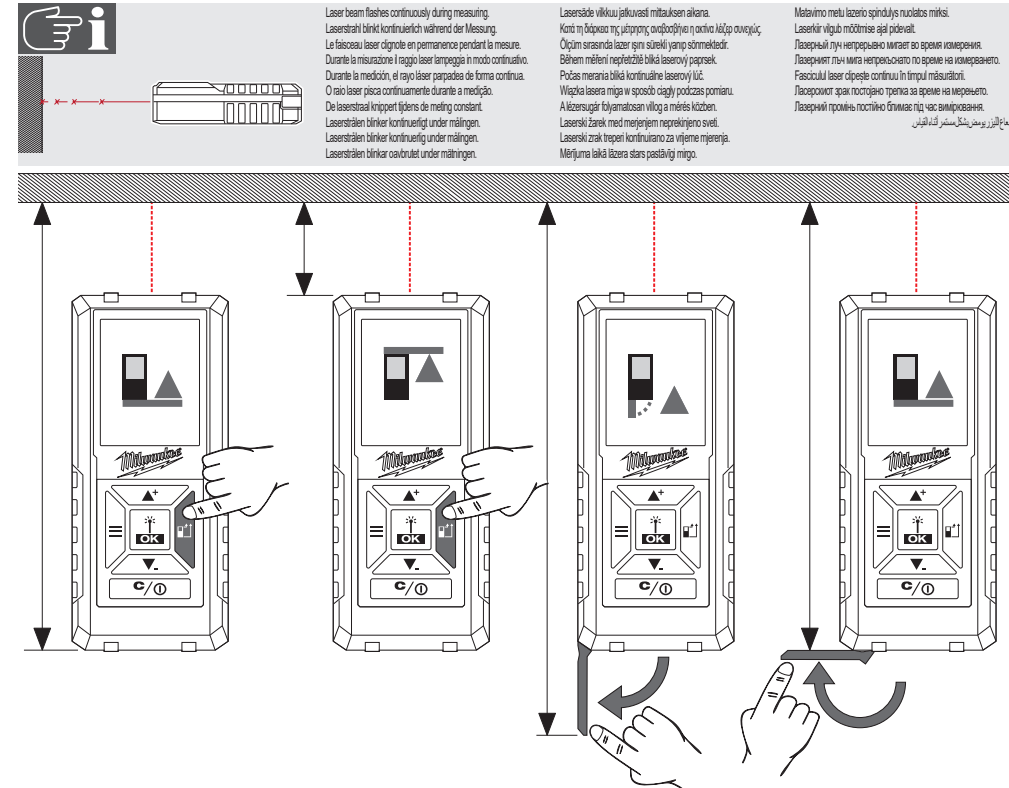

Laser beam flashes continuously during measuring.  
Laserstrahl blinkt kontinuierlich während der Messung.  
Le faisceau laser clignote en permanence pendant la mesure.  
Durante la misurazione il raggio laser palpeggia in modo continuo.  
Durante la medición, el rayo láser parpadea de forma continua.  
O raio laser pisca continuamente durante a medição.  
De laserstraal knippert tijdens de meting constant.  
Laserstrålen blinker kontinuerligt under mätningen.  
Laserstrålen blinker kontinuerligt under mätningen.  
Laserstrålen blinker kontinuerligt under mätningen.

Lasersåde vilkuvu jatuvasti mitauksen aikana.  
Kotiväliä laseri säde välillä jatkuvasti välillä laseri säde välillä.  
Ölçüm sırasında lazer ışını sürekli olarak sönmektedir.  
Bâhem mîleri nîpîzîbîlî bilkî laserovî paprsek.  
Počas merania blîkî kontînuálne laserovî kûz.  
Wizka lasera mîga w sposób ciągły podczas pomiaru.  
A lézersugár folyamatosan villog a mérés közben.  
Laserski zrak med merjenjem neprekinjeno svetlî.  
Laserski zrak med merjenjem neprekinjeno svetlî.  
Laserski zrak med merjenjem neprekinjeno svetlî.  
Laserski zrak med merjenjem neprekinjeno svetlî.  
Mîrijuma lakî laserâ stars pastâvîgi mîgo.

Matavimo metu lazerio spindulys nuolatis mirksi.  
Laseris vilgo mûbimise âjâl pûdevali.  
Лазерный луч непрерывно мигает во время измерения.  
Лазерный луч мига непрерывно по време на измерването.  
Fasciculu laser clignote continuu în timpul măsurătorii.  
Лазерикот зрак постојано трепка за време на мерењето.  
Лазерний промінь постійно блимає під час вимрювання.  
تباع الؤزر بومئى بشكل مستمر فة التوقى

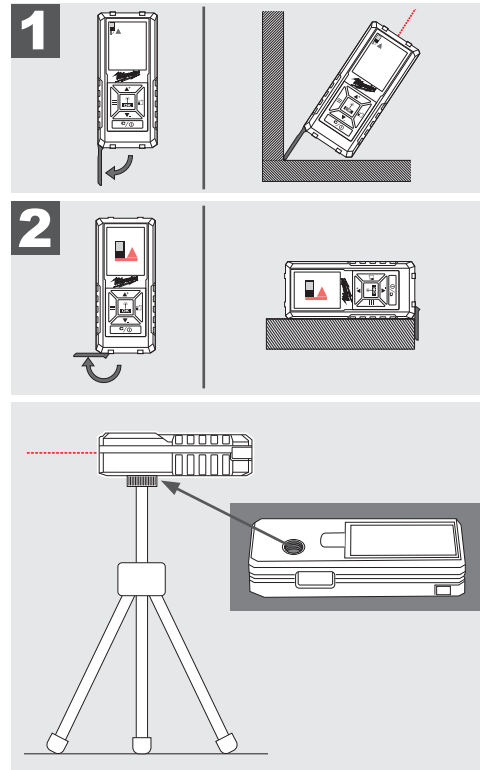
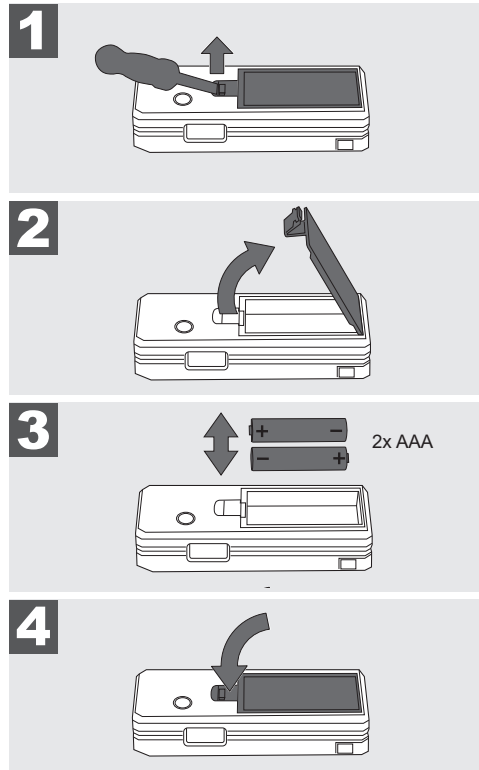

## LDM 45, LDM 100 Quickstart Guide



EN 60825-1:2014  
< 1 mW, 635 nm

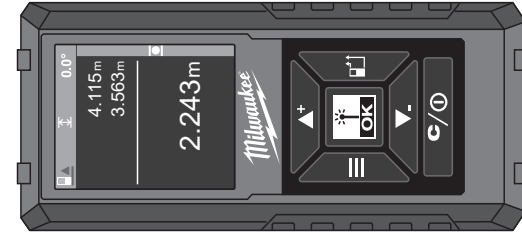

Original instructions  
Originalbetriebsanleitung  
Notice originale  
Istruzioni originali  
Manual original  
Oorspronkelijke  
gebruiksaanwijzing  
Original brugsanvisning  
Original bruksanvisning  
Bruksanvisning i original  
Alkuperäiset ohjeet  
Πρωτότυπο οδηγίων χρήσης  
Orijinal işletme talimatı  
Původním návodem k používání

Původný návod na použitie  
Instrukcja oryginalna  
Eredeti használati utasítás  
Izvirna navodila  
Originalne pogonske upute  
Instrukcijām oriģinālvaiodā  
Originali instrukcija  
Algupärane kasutusjuhend  
Оригинальное руководство по эксплуатации  
Оригинално ръководство за експлоатация  
Instrucţiuni de folosire originale  
Оригинален прирачник за работа  
Оригинал інструкції з експлуатації  
التعليمات الأصلية

Copyright 2021  
Techtronic Industries GmbH  
Max-Eyth-Str. 10  
71364 Winnenden  
Germany  
+49 (0) 7195-12-0  
[www.milwaukeetool.eu](http://www.milwaukeetool.eu)  
Techtronic Industries (UK) Ltd  
Parkway  
Marlow SL7 1YL  
UK  
(12.21)  
4931 4706 59

<https://webservice.ttigroup.eu/s3/catalog/4933459277.pdf>